

dormakaba skyra padlocks

Robust, waterproof mechatronics

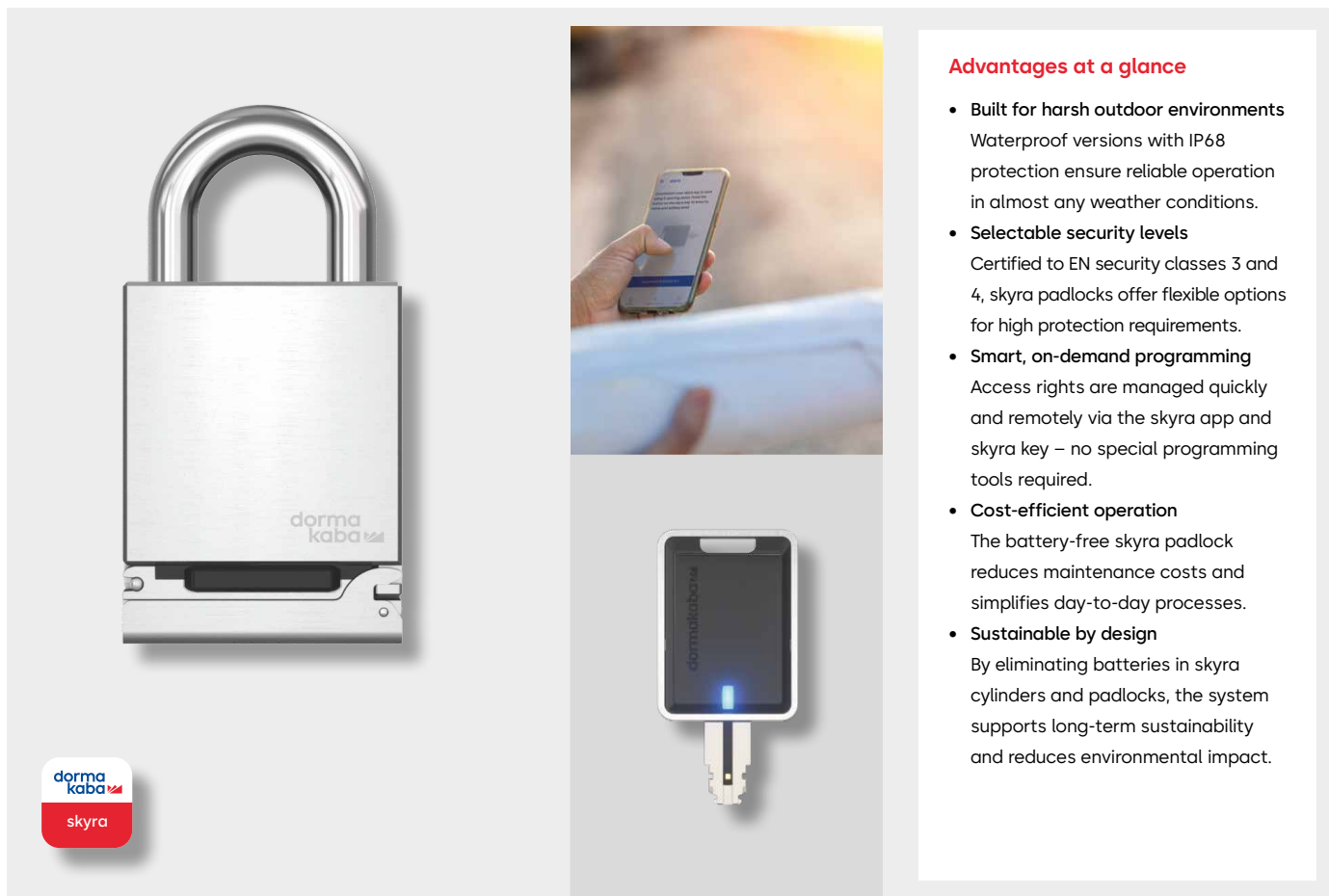

Advantages at a glance

- **Built for harsh outdoor environments**
Waterproof versions with IP68 protection ensure reliable operation in almost any weather conditions.
- **Selectable security levels**
Certified to EN security classes 3 and 4, skyra padlocks offer flexible options for high protection requirements.
- **Smart, on-demand programming**
Access rights are managed quickly and remotely via the skyra app and skyra key – no special programming tools required.
- **Cost-efficient operation**
The battery-free skyra padlock reduces maintenance costs and simplifies day-to-day processes.
- **Sustainable by design**
By eliminating batteries in skyra cylinders and padlocks, the system supports long-term sustainability and reduces environmental impact.

A digital access control system for critical infrastructure

skyra is designed for operators of critical infrastructure and organizations with widely distributed sites. This on-demand solution meets the strictest requirements for access control and security.

The battery-free, mechatronic inserts of skyra padlocks connect seamlessly to the central management system, delivering all the benefits of a modern electronic locking solution.

Power and communication are supplied via the skyra key. Thanks to their robust construction, skyra padlocks are ideal for outdoor use and extreme conditions.

Intuitive access with secure data transmission

Access is granted simply by inserting the skyra key, which instantly checks access rights and unlocks the padlock. Event data is stored in the lock, transferred to the key, and securely transmitted via Bluetooth® and mobile network to the central management system.

All access and system data is end-to-end encrypted – from the cloud to each padlock – ensuring compliance with the highest IT security and data protection standards.

Modular portfolio for every access scenario

Manufactured in Europe, the skyra padlock range is built with durable components and certified quality.

Operators of critical infrastructure benefit from a wide, interoperable selection of locking components suitable for almost every door and access point.

This modular concept enables customized, scalable solutions that meet the highest demands in both physical and organizational security.

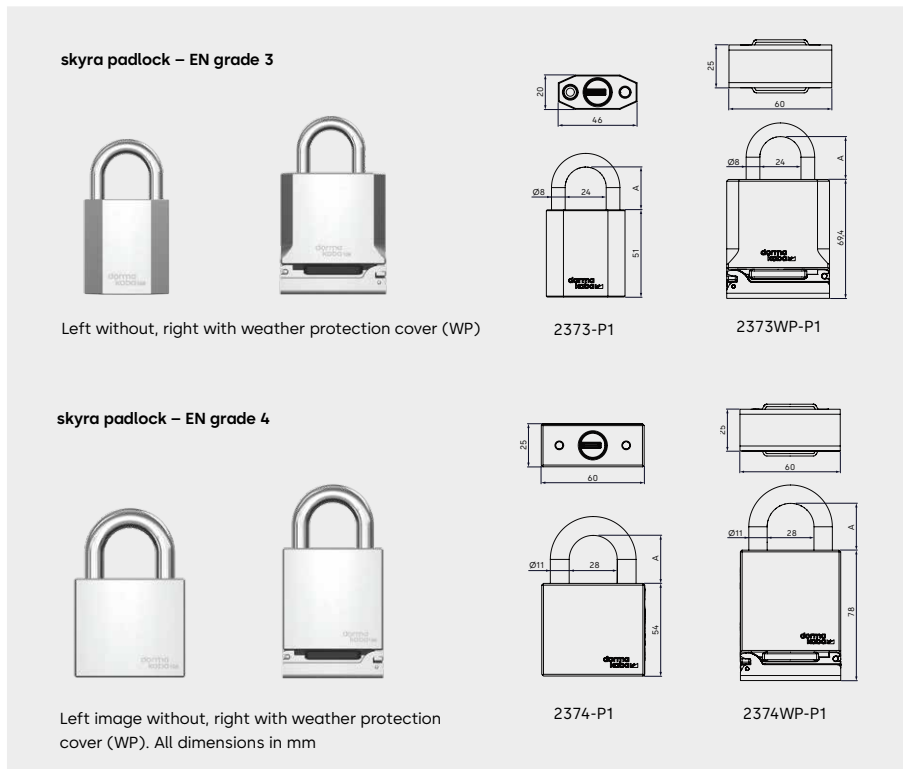

Features & handling

- **Proven quality:** Robust mechanical padlocks Made in Europe combined with smart mechatronics from skyra.
- **Certified security:** Independently tested according to EN 16864.
- **Dust & weather protection:** Models without a cover feature an integrated dust shield for low-maintenance operation.
- **Easy handling (WP version):** The WP cover opens and closes with one hand – an innovative solution for reliable protection against the elements.
- **Full waterproofing (WP version):** Shackle and mechanism are sealed with O-rings, providing complete protection against water and dirt.
- **Simple access management:** Access rights are updated via the skyra key – no modifications at the padlock required.
- **Integrated event memory:** Logs time-stamped events and transfers access data to the skyra key.

Note:

Technical specifications subject to change. Functionality depends on the selected system environment. For ordering information, please refer to the relevant dormakaba catalog or system description. The Bluetooth® word mark and logos are registered trademarks of Bluetooth SIG, Inc. WN 5622251532 | Version EN, 09/2025. © dormakaba.

Technical data

Construction & materials

- **skyra padlock EN grade 3**
Body: Chrome-plated brass
Shackle: Stainless steel, Ø 8 mm
- **skyra padlock EN grade 4**
Body: Hardened steel
Shackle: Hardened steel, Ø 11 mm

Surface finish

- Matte chrome-plated

Variants

All types also available as WP weather-protected cover version with IP68 rating.

Shackle heights:

- Grade 3: 25, 60, 110 mm
- Grade 4: 28, 50 mm

Function

- Key removable only in locked position

Security

- AES-128 encryption
- Individual security keys per padlock

Event memory

- Stores up to 500 events

Service life

- Minimum 10,000 locking cycles
- Minimum 10 years

Environmental conditions:

- Temperature range: -25 °C to +70 °C
- Protection class standard: IP55 (insert with dust cover)
- Protection class WP: IP66 & IP68

Corrosion resistance (EN 1670)

- Surface: 240 h (class 4)
- Function: 480 h (class 5)

Certifikates

- EN 16864: 1 15 4 0 D 3 X (X = grade 3 and 4) – in preparation
- LPCB certification – in preparation

Compliance

CE, UKCA, RoHS, REACH



Any questions? We will be happy to assist you.

dormakaba International Holding AG | Hofwisenstrasse 24 | CH-8153 Rümlang | info.de@dormakaba.com | dormakaba.com