

# Push pull plate

## General hardware







# Our dormakaba team

dormakaba has a skilled team of specification writers ready to discuss your project in detail. Offering a free, no-obligation hardware scheduling service. This ensures that budget and compliance considerations are always taken into account.

# Effortless and efficient...

dormkaba's push and pull entrance handles are made from 2mm thick, 304 grade stainless steel. They are suitable for installation on both timber and aluminium doors making them the ideal choice for commercial, industrial, and residential applications.

They are available in two sizes and have a cylinder hole option for the 100mm widths. Cylinder holes can be in either oval cylinder or round nightlatch cylinder cut outs.

The 316 grade stainless steel D-Pull is available in either a 150mm or 200mm depending on the plate configuration.

These pull plates comply with AS1428.1 which requires hand clearance of between 35mm and 45mm from the plate face to the underside of the handle.

## **Features:**

- 316-grade stainless steel
- 304-grade stainless steel
- 2mm thick plate
- Concealed and visible fix
- Welded Lugs for concealed fixing
- AS1428.1 compliant
  - accessibility standards

## **Sizes available**

- 300mm x 75mm
- 300mm x 100mm

# 3075 series

## Push and pull plate furniture

Concealed and visible fix stainless steel push and pull plates for fixing back to back through the door.

### Applications

Schools, hospitals, kitchen facilities, toilet airlock entries, pivot doors, cupboards and other commercial applications.

### Features

Stainless steel plates 2mm in thickness with 15mm radius corners eliminating sharp corners often associated with square cornered plates.

### Door Thickness

Screws suit door thickness up to 60mm as standard. Plates requiring extended fixing screws are available on application. Pull handles supplied on their own are suitable for door thickness to 50mm

### Plate Size

300 x 75mm x 2mm

### Pull Handle Size

150mm centres x 16mm diameter

200mm centres x 16mm diameter

Pull handles can be ordered separately and supplied with fixing bolts for doors up to 50mm thick

### Finish

Satin stainless steel



3075C5SS







3075C-H15SS



3075C-H20SS

# 3075 series

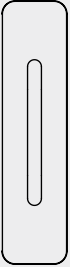
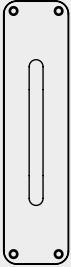
## Functions

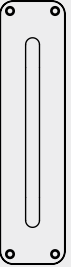
Push Plate 3075 push plate		Pull Handles on Plate 3075 push plate with 150mm D-pull		Pull Handles on Plate 3075 push plate with 200mm D-pull	
					
3075CSSS	3075VSSS	3075C-H15SSS	3075V-H15SSS	3075C-H20SSS	3075V-H20SSS

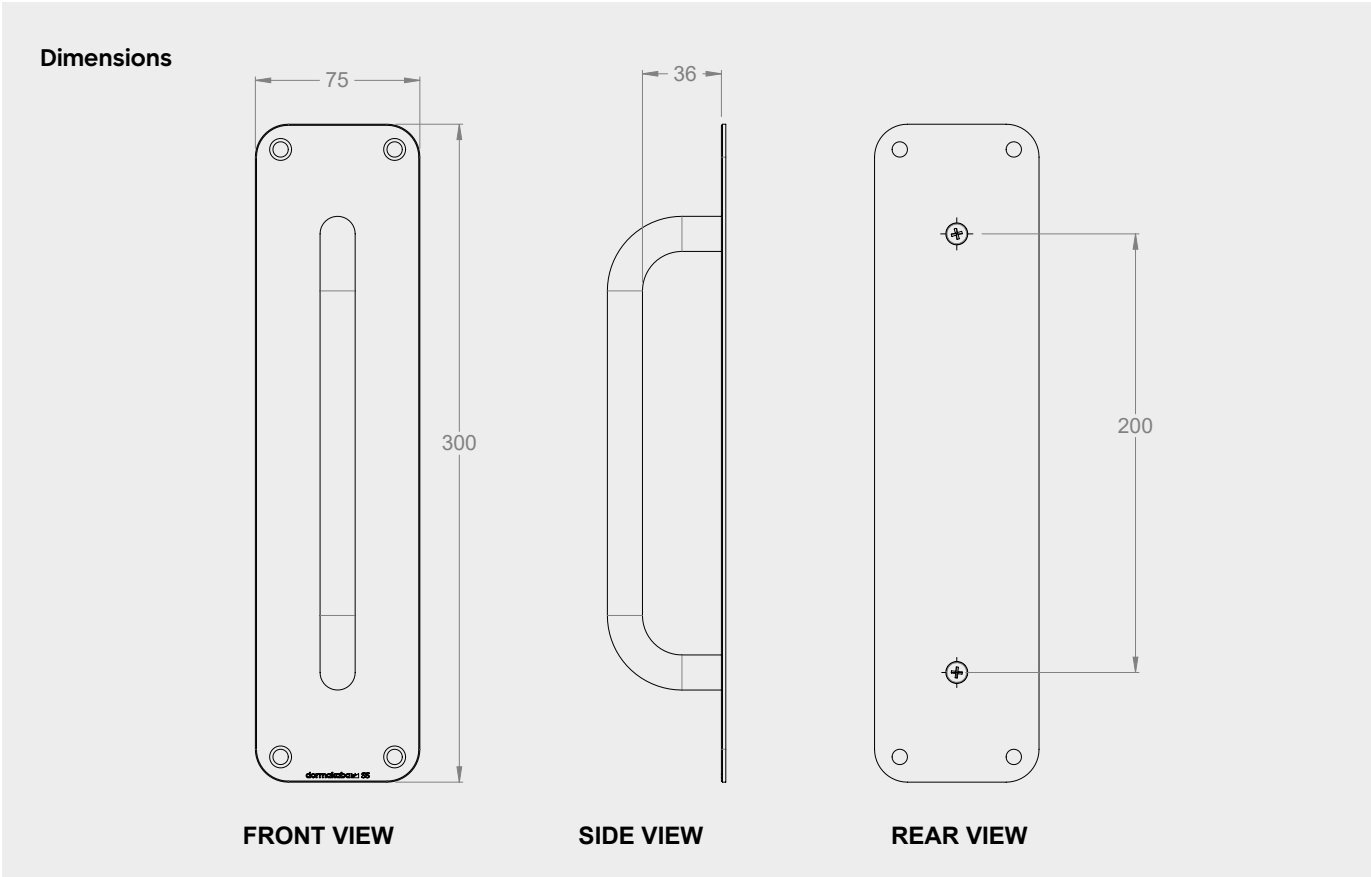



# 3010 series

## Push and pull plate furniture

Concealed and visible fix stainless steel push and pull plates for fixing back to back through the door.

### Applications

Schools, hospitals, kitchen facilities, toilet airlock entries, pivot doors, cupboards and other commercial applications.

### Features

Stainless steel plates 2mm in thickness with 15mm radius corners eliminating sharp corners often associated with square cornered plates.

### Door Thickness

Screws suit door thickness up to 60mm as standard. Plates requiring extended fixing screws are available on application. Pull handles supplied on their own are suitable for door thickness to 50mm

### Plate Size

300 x 100mm x 2mm

### Pull Handle Size

150mm centres x 16mm diameter

200mm centres x 16mm diameter

Pull handles can be ordered separately and supplied with fixing bolts for doors up to 50mm thick

### Finish

Satin stainless steel



3010C5SS

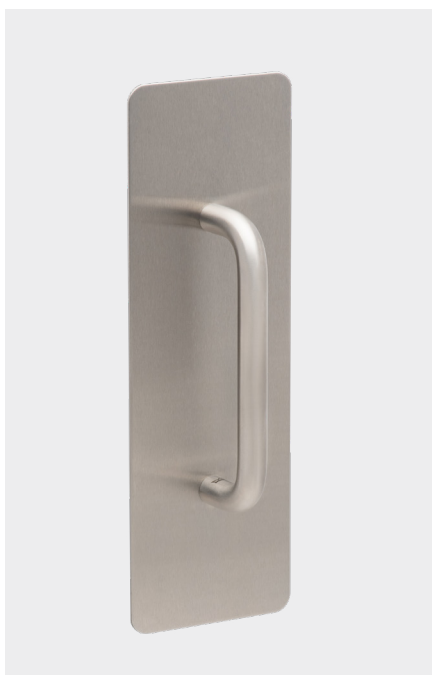

3010C-H15SS

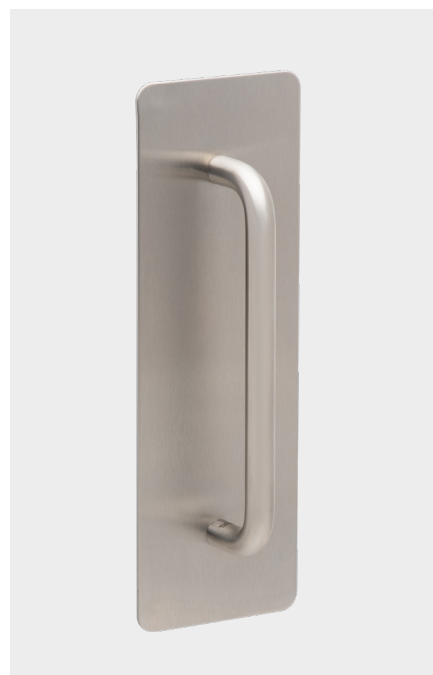

3010C-H20SS

# 3010 series

## Functions

**Push Plate**

3010 push plate

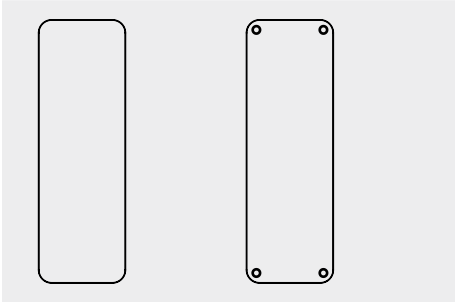

3010CSSS

3010VSSS

**Pull Handles on Plate**

3010 push plate with 150mm D-pull

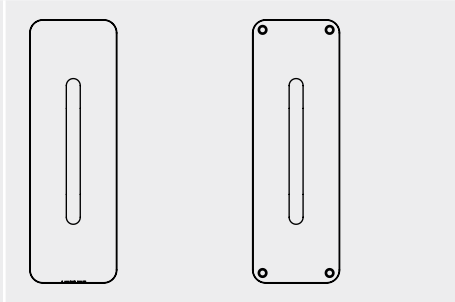

3010C-H15SSS

3010V-H15SSS

**Pull Handles on Plate**

3010 push plate with 200mm D-pull

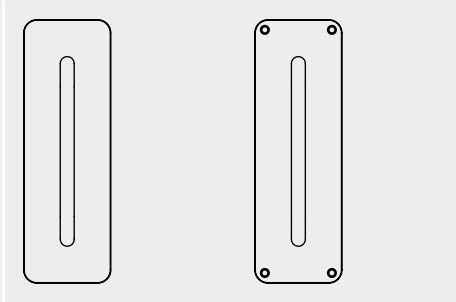

3010C-H20SSS

3010V-H20SSS

**Push Plate with Oval Hole**

3010 push plate

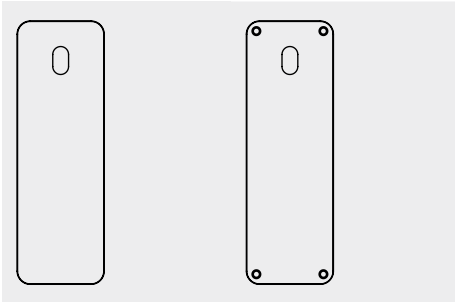

3010C/2SSS

3010V/2SSS

**Pull Handles on Plate with Oval Hole**

3010 push plate with 150mm D-pull

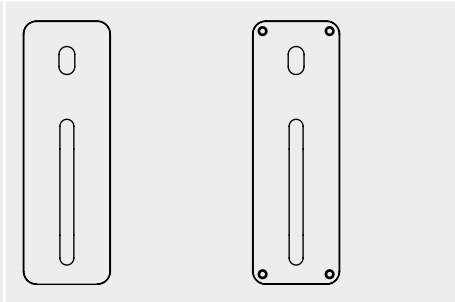

3010C-H15/2SSS

3010V-H15/2SSS

**Push Plate with Round Hole**

3010 push plate

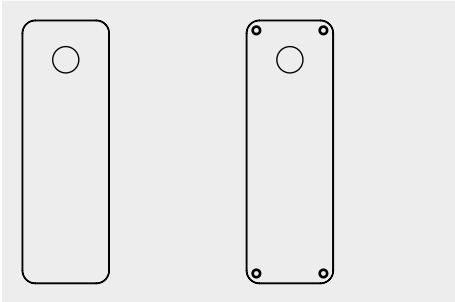

3010C/3SSS

3010V/3SSS

**Pull Handles on Plate with Round Hole**

3010 push plate with 150mm D-pull

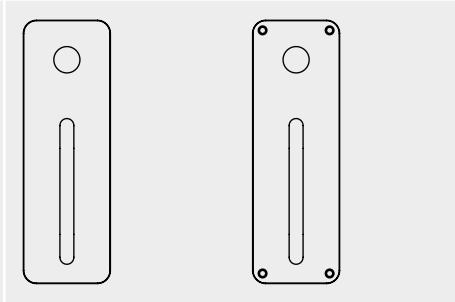

3010C-H15/3SSS

3010V-H15/3SSS

Dimensions

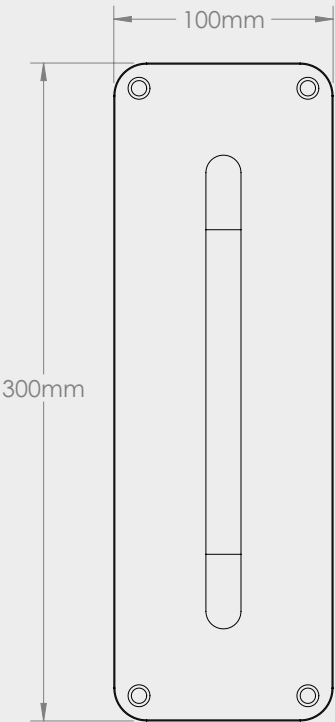

FRONT VIEW

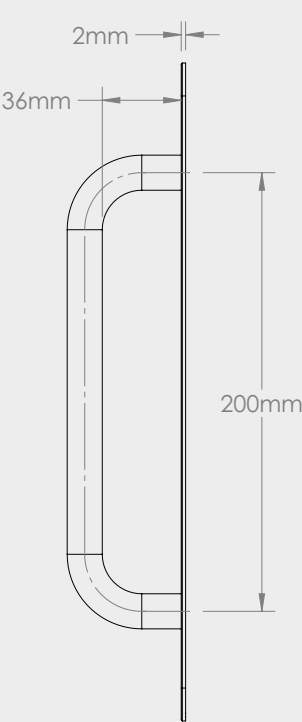

SIDE VIEW



REAR VIEW



# D-Pull handles

## 316 grade stainless steel

dormakaba D-Pulls are constructed from 316 grade stainless steel.

The 16mm diameter handle is the perfect measurement for use on utility cupboards, commercial toilet door airlocks and many other applications.

Complying with AS1428.1 which requires hand clearance of between 35mm and 45mm.

D-Pulls are supplied with two M5 x 60mm fixing screws and are available in two lengths being 150mm and 200mm.

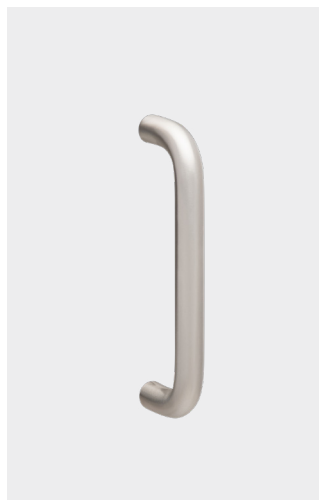

**D-Pull**  
150mm h x 16mm dia

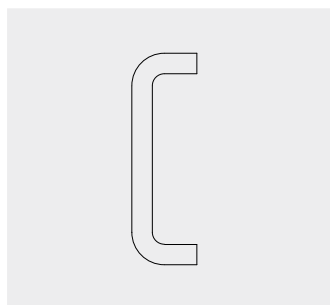

H15SSS

**D-Pull**  
200mm h x 16mm dia

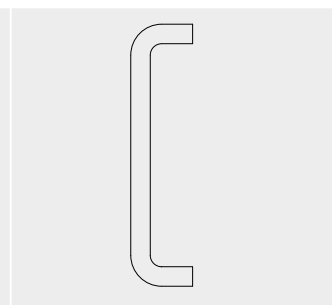

H20SSS

# Screw Pack

## M5 screws + threaded studs

The 35mm M5 screw, sold separately in the extended screw pack, suits 45mm to 60mm thick doors.

Standard 25mm M5 screws are included with all concealed fixed plates and suit 35mm to 45mm thick doors.

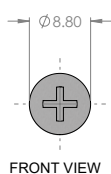

FRONT VIEW

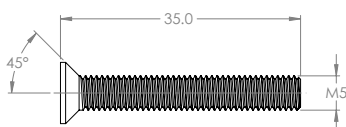

SIDE VIEW

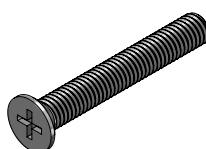

ISOMETRIC VIEW

# Ordering details

Item	Article Number	Description	Finish	
<b>30 10 Series SSS</b>				
R30 10-SET2 300X100 R30 10C/R30 10V-H20 SSS	9400000017456	R30 10 SET2 300X100 PUSH/PULL PLATE CONSISTS OF 30 10C AND 30 10V-H20 SSS	SSS	●
R30 10-SET1 300X100 R30 10C/R30 10V-H15 SSS	9400000017455	R30 10 SET1 300X100 PUSH/PULL PLATE CONSISTS OF 30 10C AND 30 10V-H15 SSS	SSS	●
R30 10C 300X100 PUSH PLT C/F SSS	9400000017453	R30 10C 300X100 PUSH PLATE CONCEALED FIX SSS	SSS	●
R30 10V 300X100 PUSH PLT V/F SSS	9400000017454	R30 10V 300X100 PUSH PLATE VISIBLE FIX SSS	SSS	●
R30 10C-H15 300X100 PULL PLT C/F SSS	9400000017457	R30 10C-H15 300X100 150MM D PULL ON PLATE CONCEALED FIX SSS	SSS	●
R30 10V-H15 300X100 PULL PLT V/F SSS	9400000017458	R30 10V-H15 300X100 150MM D PULL ON PLATE VISIBLE FIX SSS	SSS	●
R30 10C/2 300X100 PUSH PLT CYL C/F SSS	9400000017459	R30 10C/2 300X100 PUSH PLATE WITH OVAL CYLINDER HOLE CONCEALED FIX SSS	SSS	●
R30 10V/2 300X100 PUSH PLT CYL V/F SSS	9400000017460	R30 10V/2 300X100 PUSH PLATE WITH OVAL CYLINDER HOLE VISIBLE FIX SSS	SSS	●
R30 10C-H15/2 300X100 PULL PLT CYL C/FSSS	9400000017461	R30 10C-H15/2 300X100 150MM D PULL ON PLATE WITH OVAL CYLINDER HOLE CONCEALED FIX SSS	SSS	●
R30 10V-H15/2 300X100 PULL PLT CYL V/FSSS	9400000017462	R30 10V-H15/2 300X100 150MM D PULL ON PLATE WITH OVAL CYLINDER HOLE VISIBLE FIX SSS	SSS	●
R30 10C/3 300X100 PUSH PLT OVAL C/F SSS	9400000017463	R30 10C/3 300X100 PUSH PLATE WITH ROUND CYLINDER HOLE CONCEALED FIX SSS	SSS	○
R30 10V/3 300X100 PUSH PLT OVAL V/FSSS	9400000017464	R30 10V/3 300X100 PUSH PLATE WITH ROUND CYLINDER HOLE VISIBLE FIX SSS	SSS	○
R30 10C-H15/3 300X100 PULL PLT OVAL CFSSS	9400000017465	R30 10C-H15/3 300X100 150MM D PULL ON PLATE WITH ROUND CYLINDER HOLE CONCEALED FIX SSS	SSS	○
R30 10V-H15/3 300X100 PULL PLT OVAL VFSSS	9400000017466	R30 10V-H15/3 300X100 150MM D PULL ON PLATE WITH ROUND CYLINDER HOLE VISIBLE FIX SSS	SSS	○
R30 10C-H20 300X100 PULL PLT C/F SSS	9400000017467	R30 10C-H20 300X100 200MM D PULL ON PLATE CONCEALED FIX SSS	SSS	●
R30 10V-H20 300X100 PULL PLT V/F SSS	9400000017468	R30 10V-H20 300X100 200MM D PULL ON PLATE VISIBLE FIX SSS	SSS	●
<b>30 10 Series SF</b>				
R30 10-SET2 300X100 R30 10C/R30 10V-H20 SF	9400000017737	R30 10 SET2 300X100 PUSH/PULL PLATE CONSISTS OF 30 10C AND 30 10V-H20 SF	SF	○
R30 10-SET1 300X100 R30 10C/R30 10V-H15 SF	9400000017750	R30 10 SET1 300X100 PUSH/PULL PLATE CONSISTS OF 30 10C AND 30 10V-H15 SF	SF	○
R30 10C 300X100 PUSH PLT C/F SF	9400000017748	R30 10C 300X100 PUSH PLATE CONCEALED FIX SF	SF	○
R30 10V 300X100 PUSH PLT V/F SF	9400000017749	R30 10V 300X100 PUSH PLATE VISIBLE FIX SF	SF	○
R30 10C-H15 300X100 PULL PLT C/F SF	9400000017751	R30 10C-H15 300X100 150MM D PULL ON PLATE CONCEALED FIX SF	SF	○
R30 10V-H15 300X100 PULL PLT V/F SF	9400000017752	R30 10V-H15 300X100 150MM D PULL ON PLATE VISIBLE FIX SF	SF	○
R30 10C/2 300X100 PUSH PLT CYL C/F SF	9400000017753	R30 10C/2 300X100 PUSH PLATE WITH OVAL CYLINDER HOLE CONCEALED FIX SF	SF	○
R30 10V/2 300X100 PUSH PLT CYL V/F SF	9400000017754	R30 10V/2 300X100 PUSH PLATE WITH OVAL CYLINDER HOLE VISIBLE FIX SF	SF	○

# Ordering details

Item	Article Number	Description	Finish	
R3010C-H15/2 300X100 PULL PLT CYL C/F SF	9400000017755	R3010C-H15/2 300X100 150MM D PULL ON PLATE WITH OVAL CYLINDER HOLE CONCEALED FIX SF	SF	○
R3010V-H15/2 300X100 PULL PLT CYL V/F SF	9400000017756	R3010V-H15/2 300X100 150MM D PULL ON PLATE WITH OVAL CYLINDER HOLE VISIBLE FIX SF	SF	○
R3010C-H20 300X100 PULL PLT C/F SF	9400000017757	R3010C-H20 300X100 200MM D PULL ON PLATE CONCEALED FIX SF	SF	○
R3010V-H20 300X100 PULL PLT V/F SF	9400000017758	R3010V-H20 300X100 200MM D PULL ON PLATE VISIBLE FIX SF	SF	○
<b>3075 SERIES SSS</b>				
R3075-SET2 300X75 R3075C/R3075V-H20 SSS	9400000017448	R3075 SET2 300X75 PUSH/PULL PLATE CONSISTS OF 3075C AND 3075V-H20 SSS	SSS	●
R3075-SET1 300X75 R3075C/R3075V-H15 SSS	9400000017447	R3075 SET1 300X75 PUSH/PULL PLATE CONSISTS OF 3075C AND 3075V-H15 SS	SSS	●
R3075C 300X75 PUSH PLT C/F SSS	9400000017445	R3075C 300X75 PUSH PLATE CONCEALED FIX SSS	SSS	●
R3075V 300X75 PUSH PLT V/F SSS	9400000017446	R3075V 300X75 PUSH PLATE VISIBLE FIX SSS	SSS	●
R3075C-H15 300X75 PULL PLT C/F SSS	9400000017449	R3075C-H15 300X75 150MM D PULL ON PLATE CONCEALED FIX SSS	SSS	●
R3075V-H15 300X75 PULL PLT V/F SSS	9400000017450	R3075V-H15 300X75 150MM D PULL ON PLATE VISIBLE FIX SSS	SSS	●
R3075C-H20 300X75 PULL PLT C/F SSS	9400000017451	R3075C-H20 300X75 200MM D PULL ON PLATE CONCEALED FIX SSS	SSS	●
R3075V-H20 300X75 PULL PLT V/F SSS	9400000017452	R3075V-H20 300X75 200MM D PULL ON PLATE VISIBLE FIX SSS	SSS	●
<b>3075 SERIES SF</b>				
R3075-SET2 300X75 R3075C/R3075V-H20 SF	9400000017762	R3075 SET2 300X75 PUSH/PULL PLATE CONSISTS OF 3075C AND 3075V-H20 SF	SF	○
R3075-SET1 300X75 R3075C/R3075V-H15 SF	9400000017761	R3075 SET1 300X75 PUSH/PULL PLATE CONSISTS OF 3075C AND 3075V-H15 SF	SF	○
R3075C 300X75 PUSH PLT C/F SF	9400000017759	R3075C 300X75 PUSH PLATE CONCEALED FIX SF	SF	○
R3075V 300X75 PUSH PLT V/F SF	9400000017760	R3075V 300X75 PUSH PLATE VISIBLE FIX SF	SF	○
R3075C-H15 300X75 PULL PLT C/F SF	9400000017763	R3075C-H15 300X75 150MM D PULL ON PLATE CONCEALED FIX SF	SF	○
R3075V-H15 300X75 PULL PLT V/F SF	9400000017764	R3075V-H15 300X75 150MM D PULL ON PLATE VISIBLE FIX SF	SF	○
R3075C-H20 300X75 PULL PLT C/F SF	9400000017765	R3075C-H20 300X75 200MM D PULL ON PLATE CONCEALED FIX SF	SF	○
R3075V-H20 300X75 PULL PLT V/F SF	9400000017766	R3075V-H20 300X75 200MM D PULL ON PLATE VISIBLE FIX SF	SF	○
<b>Accessories</b>				
H15 150 X 16 D PULL	9400001010001	H15 150MM X 16MM D PULL	SSS	●
H20 200 X 16 D PULL	9400001020001	H20 200MM X 16MM D PULL	SSS	●
M5 X 35MM SCREW PACK	9400000017469	M5 X 35MM SCREW, THREADED STUD	SSS	●



Door  
Hardware



Electronic  
Access & Data



Mechanical  
Key Systems



Lodging  
Systems



Entrance  
Systems



Interior Glass  
Systems



Safe  
Locks



Service

## Our Sustainability Commitment

Our sustainability commitment We are committed to fostering a sustainable development along our entire value chain in line with our economic, environmental and social responsibilities toward current and future generations. We seek an open, transparent dialogue with all stakeholders to define strategies and actions based on clear targets and continuous improvement, and we actively report on our progress.