

# dormakaba quattro reversible key system

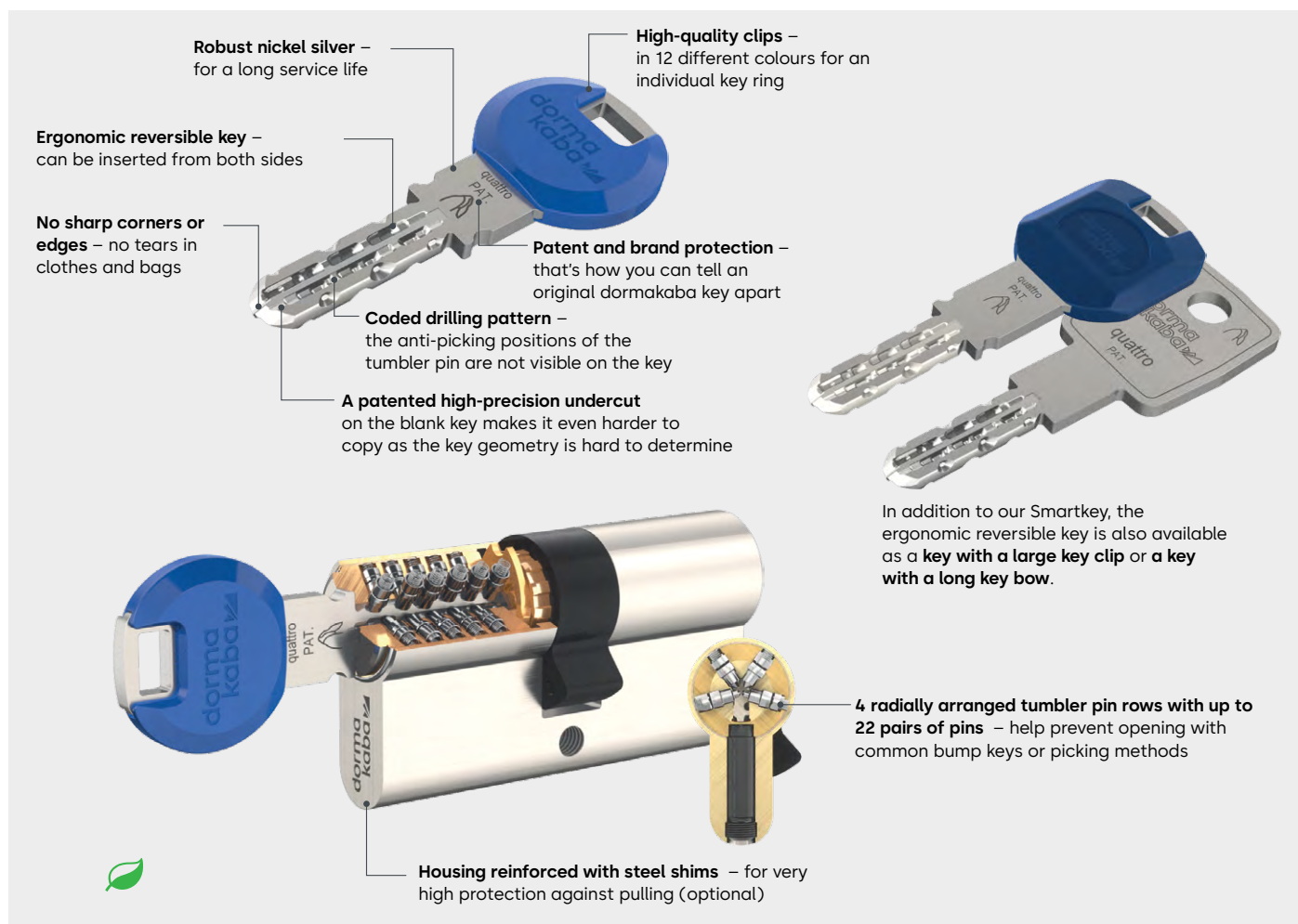

The dormakaba quattro (technical version K94) reversible key system combines convenient operation with customised protection for your master key system. Its versatility makes it ideal for securing and organising access to any building – not only to family homes and residential complexes but also to public buildings and industrial properties.

## Secure

- High level of security through compliance with relevant standards, for example EN 1303 and DIN 18252
- Long-term protection by European patent EP4261366B1\* – valid until 2043
- Technical construction protects very well against the most common opening methods

\*Not valid in all countries

– see [worldwide.espacenet.com](http://worldwide.espacenet.com) for details.

## Convenient

- Reversible key without sharp edges can be inserted from both sides
- A single key for users, with keyed-alike cylinders or in a master key system

## Flexible

- Flexible use for basic to complex master key system types
- Optional security elements for even greater protection
- Can be combined with dormakaba electronic access systems

From the  
inventor of the  
reversible key

## Inventor of the reversible key – 90 years ago

Fritz Schori developed the reversible key for Kaba in 1934. For the first time, it did not matter how the key was inserted into the keyway. The revolutionary design with no sharp edges still offers a high level of convenience and security today and has become an indispensable part of modern security technology. We have been continuously improving our reversible keys ever since that first model to give you peace of mind.

# Certified security and an array of possibilities

## Certificates

- EN 1303: Key Related Security Grade 6 and Attack Resistance Grade D for versions with steel reinforcement in the housing
- Safety standards/Certificates (expanded):
  - DIN 18252: Grade C and D
  - VdS: Grade B+ and BZ+ for corresponding special design
- Fire protection: Lock cylinder tested according to EN 1634-1 and EN 1634-2

## Keys with various forms and functions



Standard key with blue clip



Key with large key clip



Key with long nickel silver key bow



Key with RFID transponder clip for integration into electronic access control systems

## Colours as a visual aid



Smartkey clips are available in 12 colours for standard keys.



Keys with large key clip are also available in 12 different colours.



The RFID transponder clips have 6 coloured ring elements for easier identification.

## A wide range – free choice of design

The cylinder range features a wide variety of types to choose from. What's more, you can also integrate cylinders for cabinet locks, key-operated switches or lift controls into the system.

## Some cylinder lock types



DKZ, DZ and HZ



VHS



AZ



BMZ



MZ



MAS



SZ

### DKZ

Thumbturn cylinder

### DZ

Double cylinder

### HZ

Single cylinder

### VHS

Padlock

### AZ

Rim cylinder

### BMZ

Camlock

### MZ

Cylinder cabinet lock

### MAS

Furniture dead lock

### SZ

Key switch cylinder

## Added value upon request: special functions

If you have very particular requirements for your complete system or just individual doors, you can choose from a comprehensive range of special functions and special designs. For details, please refer to the 'Special functions for reversible key systems' brochure.

## Special functions: an overview

- **Temporary access for service personnel?**  
**Just turn the key!**  
Service function (SAT)
- **Key left in the lock? No problem!**  
Lock cylinder with key override on both sides (BSZ)
- **Cold and damp outside?**  
**Everything dry inside.**  
Thermally insulated lock cylinder (TIC)
- **Dust or insects?**  
**No way through.**  
Dust and insect protection (SIS)



## Our commitment to sustainability

At dormakaba, we are committed to sustainable development along our entire value chain. To give quantified data on the environmental effects of a product and its ecological footprint, dormakaba provides Environmental Product Declarations (EPD). You can find our EPDs and further information on our commitment to sustainability [here](#) or by scanning the QR code.



## Environmental Product Declaration: EPD

- In line with ISO 14025 and EN 15804+A2
- Publisher and programme holder: Institut Bauen und Umwelt e.V.

## Any questions? We would be happy to answer any you may have.

dormakaba Deutschland GmbH | DORMA Platz 1 | DE-58256 Ennepetal | [www.dormakaba.de](http://www.dormakaba.de)  
 dormakaba Luxembourg SA | Duchscherstrooss 50 | LU-6868 Wecker | [www.dormakaba.lu](http://www.dormakaba.lu)  
 dormakaba Austria GmbH | Ulrich-Bremi-Strasse 2 | AT-3130 Herzogenburg | [www.dormakaba.at](http://www.dormakaba.at)

Subject to change without notice.  
WN 5530851532, 02/25