

CL700 CYLINDRICAL LEVER LOCK INSTALLATION INSTRUCTIONS

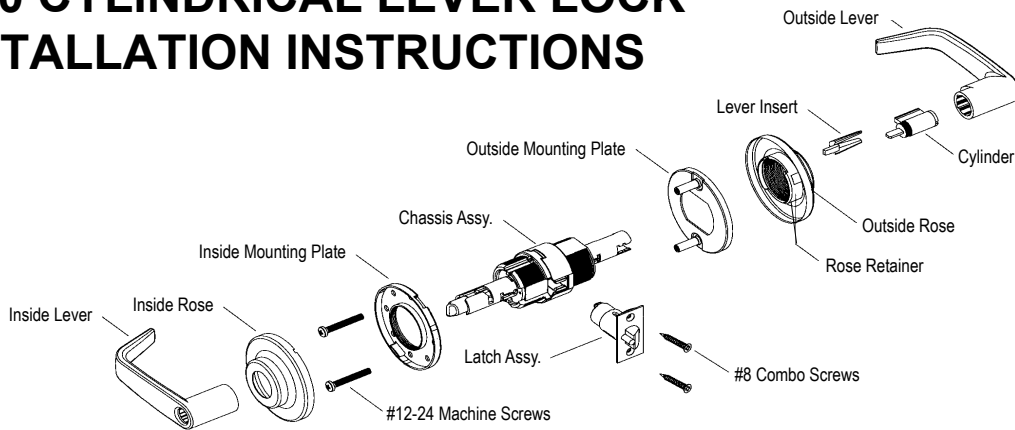

1. MARK DOOR

- Mark height line on edge of door approximately 38" from floor.
- Using the proper backset, mark 2 1/8" hole on both sides of the door.
- Mark 5/16" holes, two places on outside of the door.
- Mark the center of the door edge for the latch.

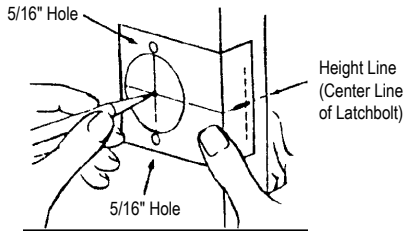

2. DOOR PREPARATION

- Bore 2 1/8" hole thru and two 5/16" holes from both sides of door to prevent splintering door finish.
- Bore 1" hole for latch on door edge.
- Using the latch faceplate as a guide, trace outline and mortise door edge so latch is flush with door.
- Install latch with screws provided.

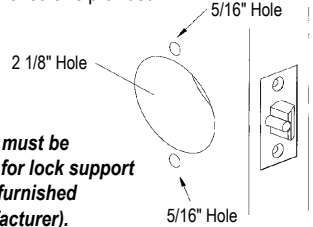

Note:
Hollow metal doors must be properly reinforced for lock support (if support was not furnished contact door manufacturer).

3. INSTALL STRIKE

- Use strike locating tool or pointed object to locate position for hole in frame.
- Bore 1" x 3/4" deep hole. Use strike as a template and mortise to the proper depth.
- If dust box is to be used, clear area with wood chisel

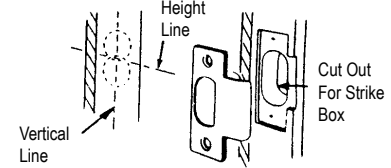

4. CHASSIS ADJUSTMENT

- Move outside mounting plate toward chassis housing.
- Rotate outside rose to required door thickness.

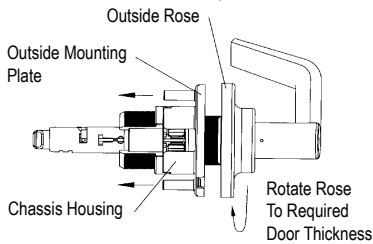

- Adjust notches in rose retainer to align with flat sides of outside mounting plate.

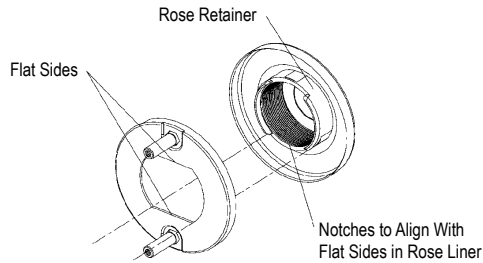

- Engage notches in rose retainer with outside mounting plate.

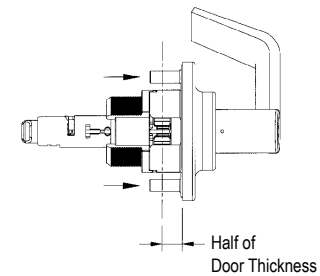

5. INSTALL OUTSIDE TRIM

- For ease of installation, lock should be in the unlocked position.
- Slide chassis assembly into door from outside making sure that lock housing engages latch prongs. Retractor must also engage latch tail.

Caution:
Do Not Attempt to Mount Lock Unit With Door Closed

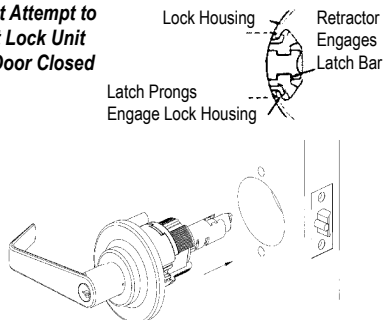

6. INSTALL INSIDE TRIM

- Screw inside mounting plate onto hub and tighten firmly by rotating plate with spanner wrench, adjust screw holes in plate to align with through bolts. (NOTE: Also adjust either one of the notches in plate towards bottom.)

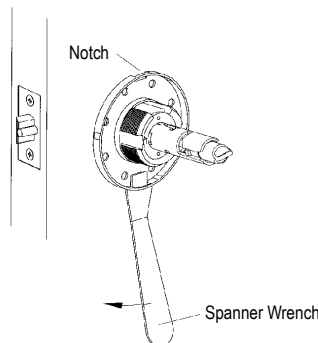

- Insert screws and tighten
- Locate the notch on edge of rose towards bottom and push in until flush with face of door.
- Align lever with spindle and push. Lever catch engages with hole.
- Check function before closing door.

