

High Security Padlock Enclosure Guard



Description:

High quality guard for high security applications including remote sites within the utility and infrastructure sectors.

A key is required to open and lock the shackle.

Suitable for universal indoor and outdoor use.

Applications

- Telecommunication cabinets
- Roadside cabinets & enclosures
- Infrastructure enclosures
- Utility enclosures
- Rail and Track-side enclosures/cases/cabinets
- Site storage containers
- Security doors
- Mesh cages
- Security kiosks
- Containers
- Portable buildings

Features:

- 98 mm Solid stainless steel body
- 13 mm stainless steel locking bolt
- Key retained when unlocked, ensures device is not left open
- Successful history, tried and tested by various third parties

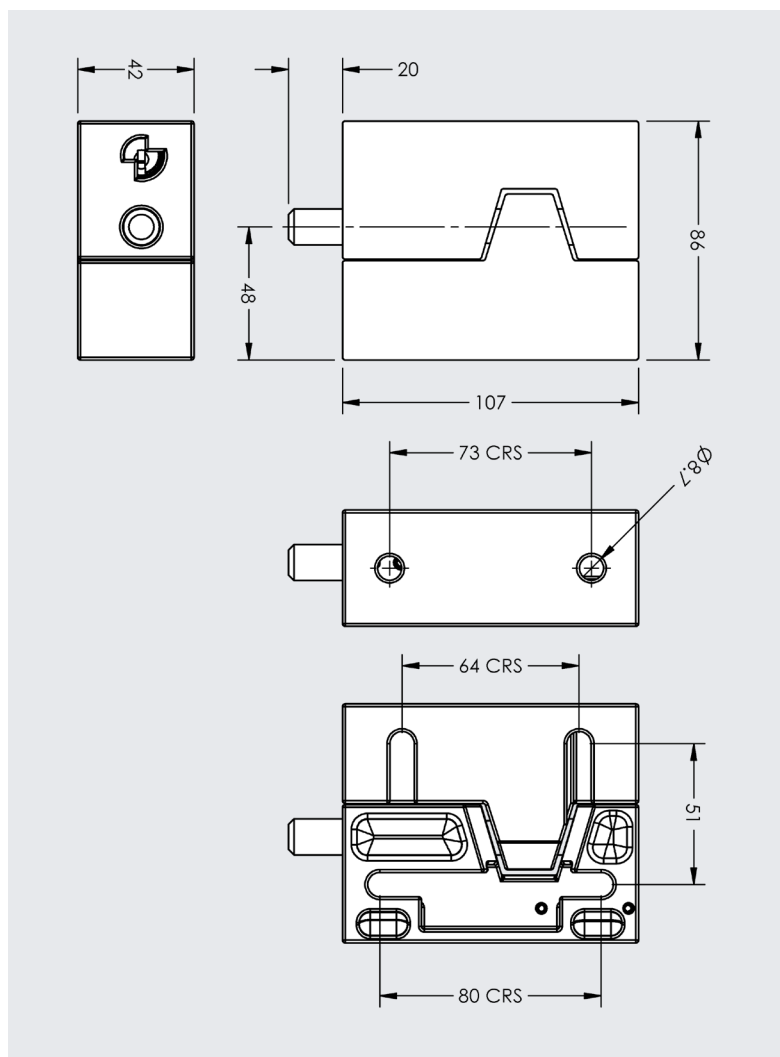

Padlock Information

Dimension A

- 28mm or 50mm

Available Patented Systems:

- Kaba 20 (K37)
- quattro plus (K85)
- expert plus (K83)

Available Legacy Systems:

- Kaba 20 (P1)
- quattro Plus (K58)
- expert (K56)

PDS-016-03

Any questions? We would be happy to advise you.

Contact us on: **01884 256464**