

ESA 500

Automatic sliding door



Standard features

- Meets ANSI/BHMA A156.10 American National Standard for Power Operated Pedestrian Doors
- Heavy-duty Delrin® rollers
- Fully monitored overhead presence and activation sensors
- Security interface
- Low maintenance
- High traffic volume
- Adjustable astragal
- Dual vertical weather sweeps
- For use with 1/2" tempered glass

Description

The ESA500 is an all glass automatic sliding door designed for applications where partial breakout of sliding panels only is required. The superior choice for interior openings, it is perfect for creating an all glass look. Suitable for large openings with possibilities for extended width sidelites.

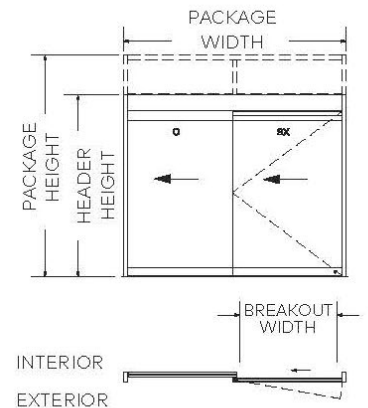
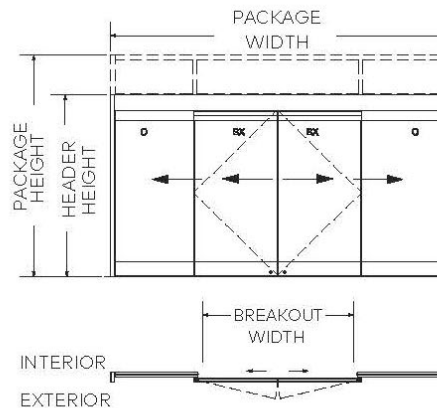

Factsheet

Telescopic packages not shown.

ESA500 Technical specifications

Configuration	
Standard finishes	Clear or Dark Bronze Anodized
Package height	up to 10'-0" (120")
Package height w/transom	up to 12'-0" (144")
Package width	[Single slide up to 8'-0"] (96") [Single slide telescopic up to 12'-0"] (144") [Bi-part slide up to 16'-0"] (192") [Bi-part telescopic up to 16'-0"] (192")
Door panels	6" Top and bottom rails Graceful lines with no vertical stiles
Jamb tubes	1-3/4" x 4-1/2" smooth or double pocket

Features	
Vertical transom mullion	One (1-3/4" x 4-1/2")
Threshold	Recessed or surface mounted
Weather stripping	Brush

Bi-parting narrow stile

	Minimum	Maximum
Overall frame width	7'-6"	16'
Rough opening width	7'-6 1/2"	16 1/2"
Clear slide opening	32"	86-1/4"
Header height	7' 4-1/2"	10'
Rough opening height	7' - 5"	10' - 1/2"
Transom height	8"	24"

Bi-parting telescopic

	Minimum	Maximum
Overall frame width	11'	16'
Rough opening width	11'-1/2"	16'-1/2"
Clear slide opening	78-1/4"	118-1/4"
Header height	7' 4-1/2"	10'
Rough opening height	7'-5"	10'-1/2"
Transom height	8"	24"

Power	
Power supply	120 V +/- 10% 50/60 Hz
Internal power supply available for accessories	27 V DC / 2 A
Fuse	6.6 A not exchangeable
Power consumption	250 W (Max)

Safety and security

Lock	Bottom rail mounted mortise lock
Sensors	Two combination motion/presence sensors
Controller	Self-learning & self-monitoring microprocessor controller
Jamb mounted rocker switch panel	Auto-off – hold open Two way traffic – exit only Full open – partial open

Single slide narrow stile

	Minimum	Maximum
Overall frame width	6'-6"	8'
Rough opening width	6' - 6 1/2"	8' - 1/2"
Clear slide opening	33-1/4"	42-1/4"
Header height	7' 4-1/2"	10'
Rough opening height	7' - 5"	10'-1/2"
Transom height	8"	24"

Single slide telescopic

	Minimum	Maximum
Overall frame width	6'-6"	12'
Rough opening width	7'-1/2"	12'-1/2"
Clear slide opening	50-1/4"	90-1/4"
Header height	7' 4-1/2"	10'
Rough opening height	7'-5"	10'-1/2"
Transom height	8"	24"

ESA500 Technical specifications

1. ANSI 156.10, ANSI A117.1
2. UL 325 compliant
3. ICC/IBC - International Building Code
4. CUL – Approved for use in Canada
5. NFPA 70 - National Electrical Code
6. NFPA 101 - Life Safety Code

Activation

Knowing act/Manual activation

1. Push or wave plates to activate door
2. Two combination motion/presence sensors



Any questions? We would be happy to advise you.

Contact us at: 800.523.8483