

Axessor Apexx

# The New Standard in Safe Locks



## Managing Safe Locks with Unprecedented Ease

The Axessor Apexx multi-lock IP platform allows you to *remotely and securely* manage an entire fleet of locks.

Through the most secure encryption, with Axessor Apexx you can remotely:

- Add or delete users
- Receive near real-time audits
- View lock user directory
- Apply security settings
- Receive active alerts

## Industry Leading Security

From the leaders in safe locks and the most trusted brands, Cencon, Auditcon, LA GARD and Axessor, comes the new standard in safe locks for cash and asset security — Axessor Apexx.

We've met the unrivaled challenge of delivering the efficiency and convenience of a networked solution, while maintaining the highest security standards. Key security features include:

- Advanced security encryption
  - TLS 1.3 network encryption
  - AES256 lock to keypad encryption
- Receive active alerts
- Remotely set security parameters

## Unmatched Convenience

Banks and retailers commonly use stand-alone locks to secure cash and assets. Stand-alone locks are costly and inefficient since they can only be configured, changed or audited manually at the keypad. Today's banking and retail markets demand more efficient solutions, which Axessor Apexx delivers, allowing you to remotely:

- Add, delete and modify user access to any lock across sites
- Easily accommodate floating personnel
- Receive audits from the lock in near real-time
- Quickly and easily view and manage a directory of users: with their lock access, settings, and permissions

## Substantial Cost Savings

As a long-standing industry partner, dormakaba understands the requirement that real value and savings drive the broad-scale adoption of new technologies. We designed Axessor Apexx to deliver a solid ROI, allowing you to:

- Eliminate costly service charges for:
  - Code changes
  - Audit data pulls
- Limit delays in managing users and audits
- Mitigate loss risk by receiving timely alerts

# Apexx Architecture & Workflow

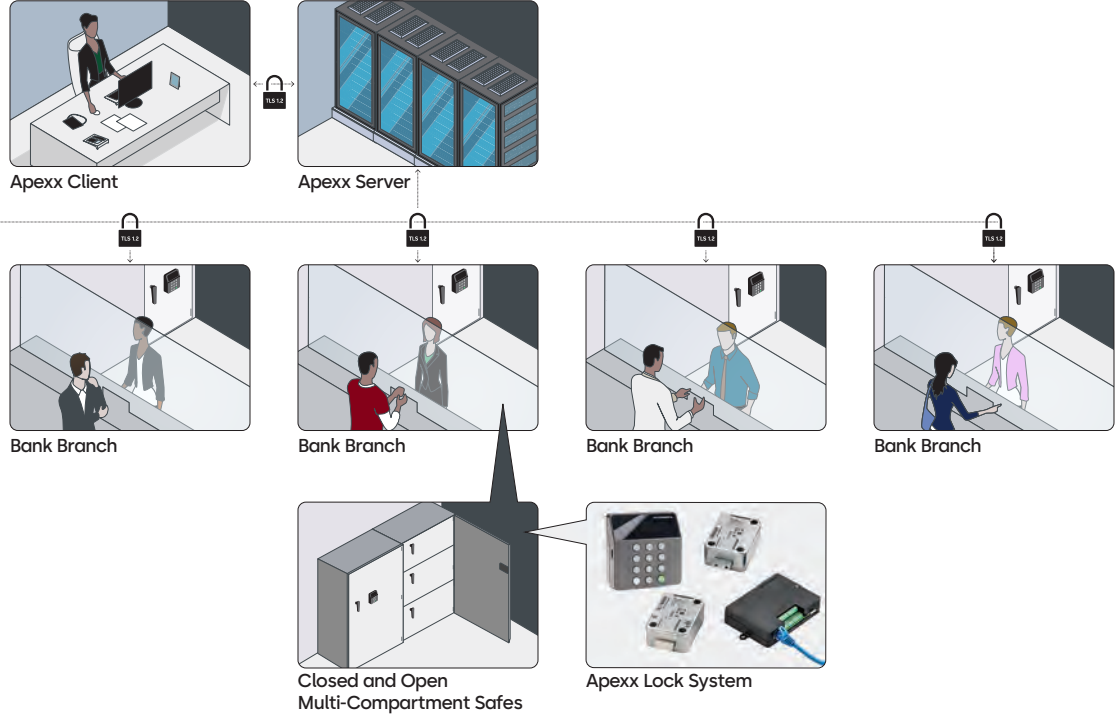

Network & Encryption	<ul style="list-style-type: none"> <li>• HTTPS Protocol TLS 1.3 for ethernet connection</li> <li>• Key exchange by ECDSA 256 bit for CAN bus</li> <li>• Data transfer symmetric encryption AES256</li> <li>• Built on RESTful API for simplified integration into company software systems</li> </ul>
Software System Requirements	<ul style="list-style-type: none"> <li>• Installation on your secure network or Windows (10/11)</li> <li>• SQL 19</li> </ul>
Display	Backlit, OLED Display, Icon driven UI
Lock Options	Motorized deadbolt and latch bolt options
Multi Lock Capacity	Up to 16 locks, 2 keypad, and a single eBox per lock system
User Capacity	Up to 1000 users per lock system
Power Management	AC line and POE options available; battery backup; USB-C emergency power
Lock System Features	Combo length: 1-10 ID + 6-12 PIN, duress alarm, programmable time lock, dual user mode, time delay (override), sequential open (multi-lock), and wrong try penalty
Audit Data	<ul style="list-style-type: none"> <li>• Automatically pushed to software on near real-time basis</li> <li>• Downloadable to CSV or PDF</li> </ul>
Automated Alerts	<ul style="list-style-type: none"> <li>• Set in software, options include: duress, door open, immediate time lock</li> <li>• More available with API integration</li> </ul>
Software Enabled Special Security Settings	Holiday schedules, lockout schedules, opening and duress time delays
Dynamic User Management	Allows for the quick and easy management of all User lock access, settings, and permissions. Dynamically maintained in Apexx Series Software



\*Pending

**Any questions? We would be happy to advise you.**

Contact us: [sales.safelocks.us@dormakaba.com](mailto:sales.safelocks.us@dormakaba.com)