

C800 CYLINDRICAL LEVERSET

Installation Instructions



Overall Exploded View

Tools required for installation  
#2 Cross drive screwdriver  
Flathead screwdriver

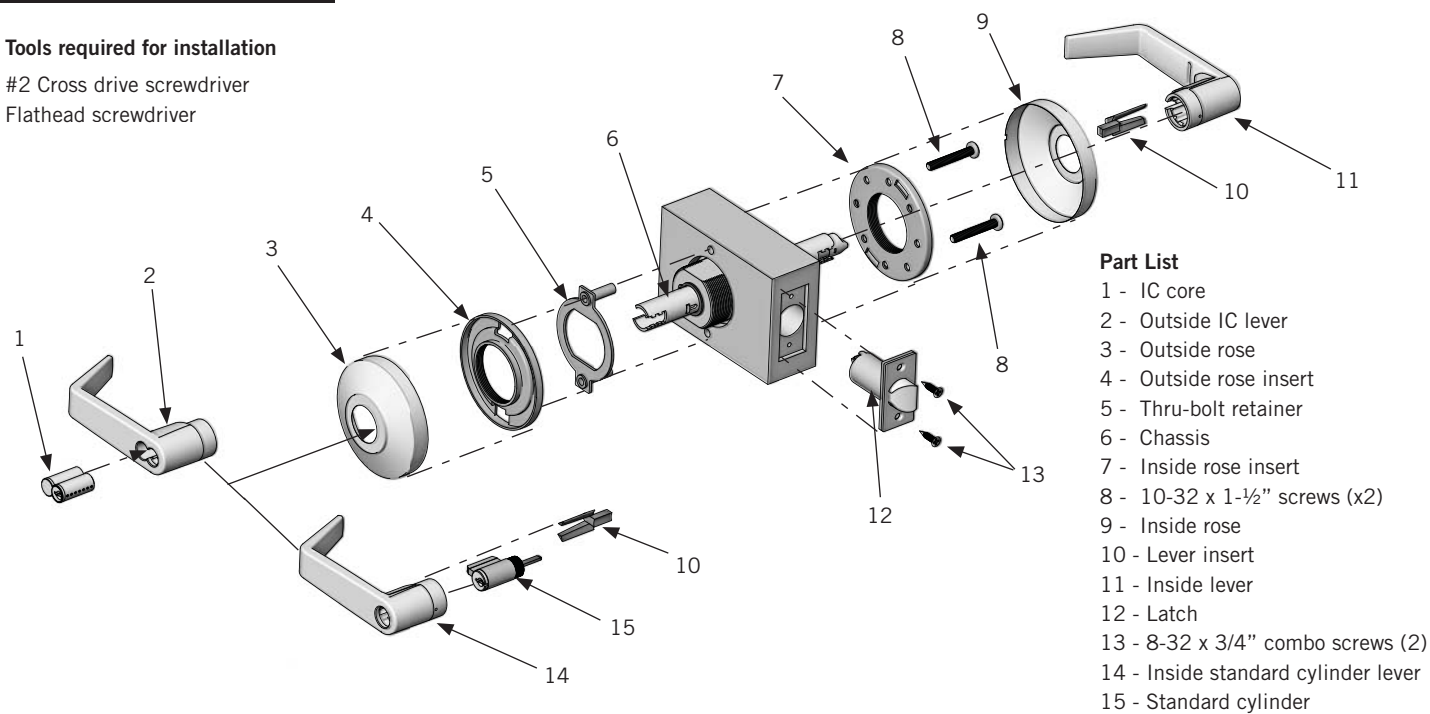

1. Install latch

- 1.1 Place the latch into the door edge.  
⚠ Orient such that the beveled edge of the latch faces the door jamb.  
1.2 Secure with two 8-32 x 3/4" combo screws.

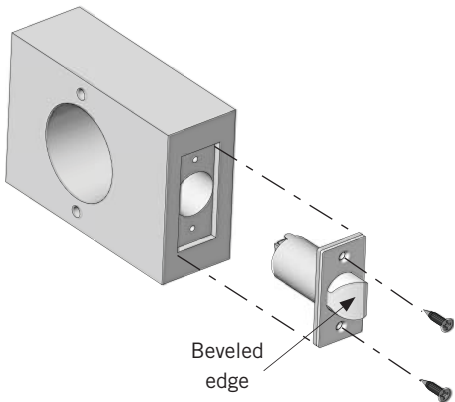

1

Optional extension instructions

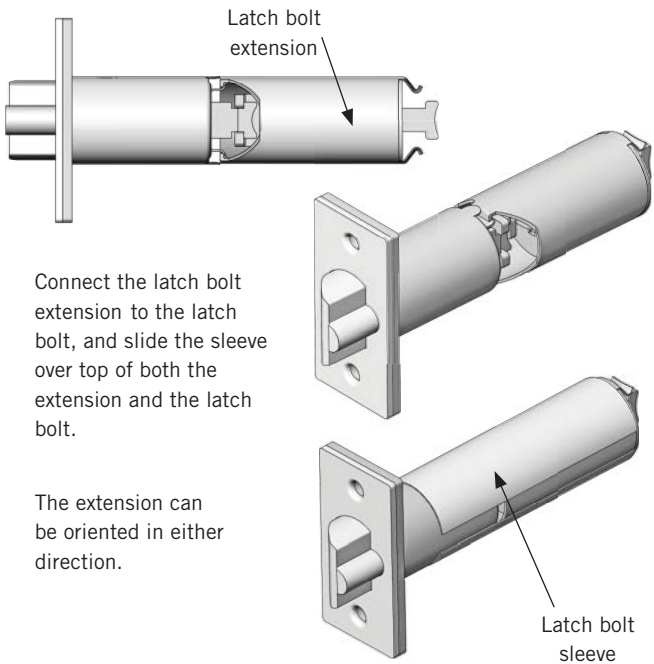

Latch bolt with extension & sleeve

2. Install lock assembly

Adjust for door thickness  
**NOTE: Lock comes adjusted for 1-3/4" door from the factory.**

- 2.1 To adjust the lock assembly for door thickness, align so the center of the chassis is in line with the center of the latch.

- 2.2 Slightly separate the thru-bolt retainer from the outside rose insert.  
2.3 Rotate the outside rose assembly to adjust for proper door thickness.  
2.4 Realign the thru-bolt retainer with the outside rose.

Install chassis

- 2.5 Slide the lock assembly into the face of the door while.  
⚠ Be sure to engage the inner latch mechanism of the chassis with the back of the latch as shown.

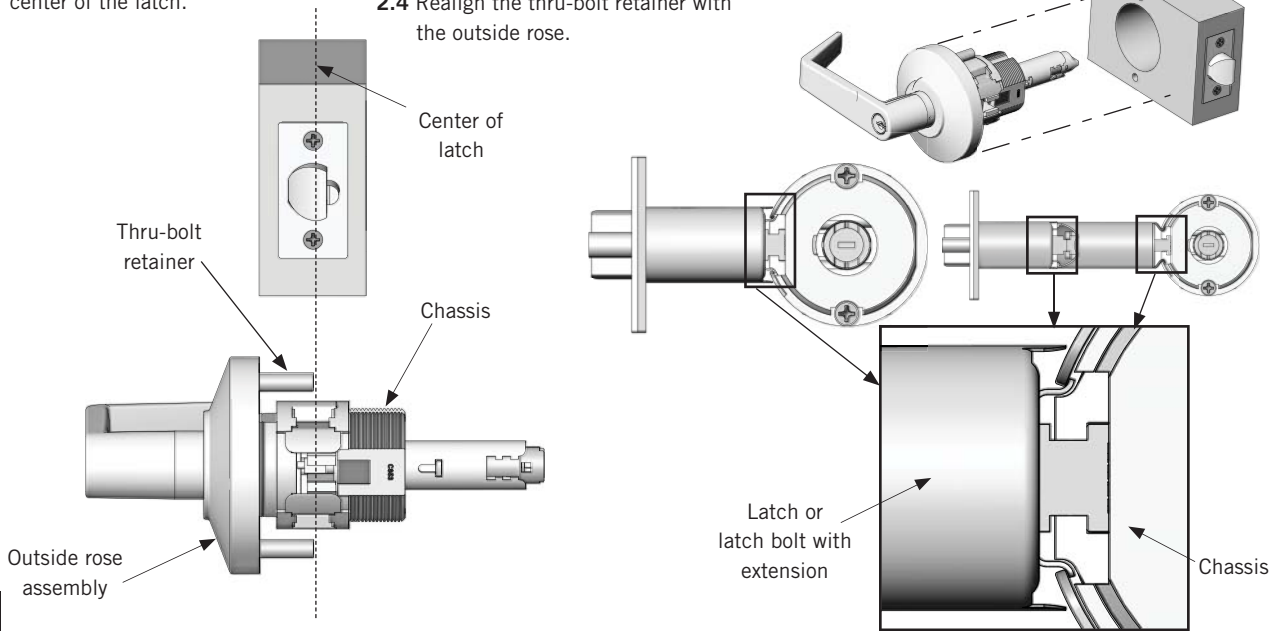

2

3. Install inside rose insert

- 3.1 Hold the lock assembly in place.  
3.2 Thread the inside rose insert onto the chassis until snug against the door.  
3.3 Insert the spanner wrench into the notch in the rose insert and tighten until aligned with the holes in the door.  
3.4 Secure the rose insert to the chassis using two 10-32 x 1-1/2" screws.

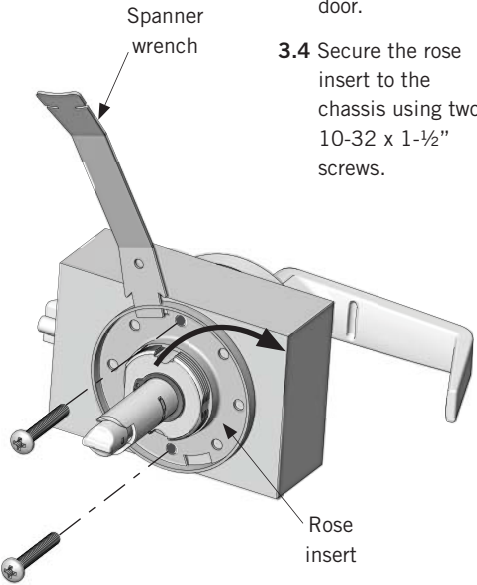

3

4. Install rose

- 4.1 Push the inside rose onto the inside rose insert oriented such that the rose notch is facing downward.

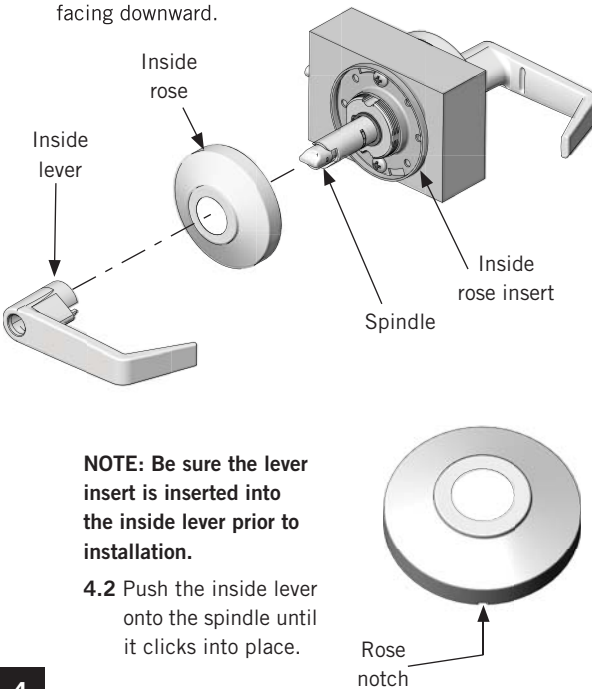

4

5. Install strikes

- 5.1 Insert strike as shown, and secure with two 12-24 x 1" combo screws.

**Strike part list**  
1 - Strike plate  
2 - Dust box  
3 - 12-24 x 1" combo-screws

Non-wood doors

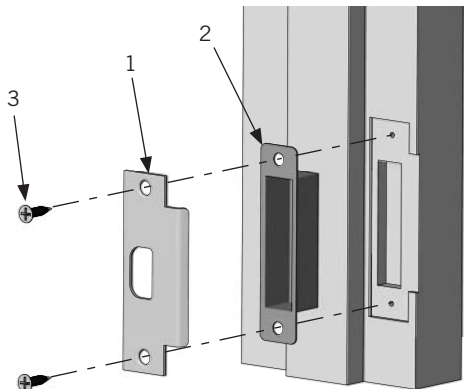

5

I. C877 - Timing instructions

Tools needed:

- flat head screw driver
- lever pick

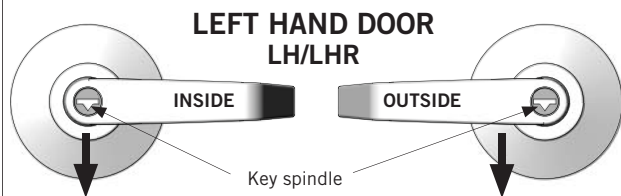
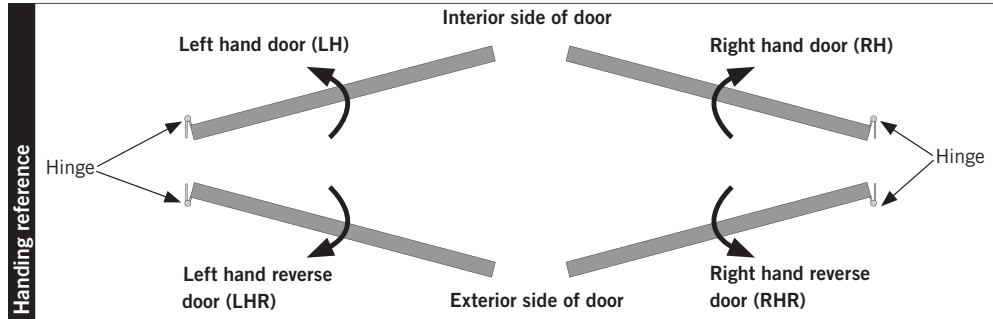

**TIMING INSTRUCTIONS:** Install lock on door. Remove both inside and outside levers (for Interchangeable Core locks, leave levers in place and remove cores and tail pieces)

**OUTSIDE OF DOOR:** Rotate key spindle until indicator is pointing **DOWN**. Install outside cylinder and lever.

**INSIDE OF DOOR:** Rotate key spindle until indicator is pointing **DOWN**. Install inside cylinder and lever.

**CHECK THE LOCK OPERATION BEFORE SHUTTING THE DOOR.**

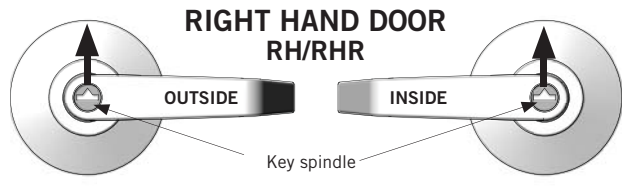

**TIMING INSTRUCTIONS:** Install lock on door. Remove both inside and outside levers (for Interchangeable Core locks, leave levers in place and remove cores and tail pieces)

**OUTSIDE OF DOOR:** Rotate key spindle until indicator is pointing **UP**. Install outside cylinder and lever.

**INSIDE OF DOOR:** Rotate key spindle until indicator is pointing **UP**. Install inside cylinder and lever.

**CHECK THE LOCK OPERATION BEFORE SHUTTING THE DOOR.**

II. C865, 870 & 872 - Timing instructions

**TIMING INSTRUCTIONS:** Install lock on door. Remove inside and/or outside levers and cylinders (for Interchangeable Core locks, leave levers in place and remove cores and tail pieces)

*865 = inside lever only*  
*870 = outside lever only*  
*872 = inside and outside levers*

**INSIDE/ OUTSIDE OF DOOR:**

Rotate key spindle fully **counter-clockwise**. Install cylinder and lever. (See steps 3 & 4 in section IV.)

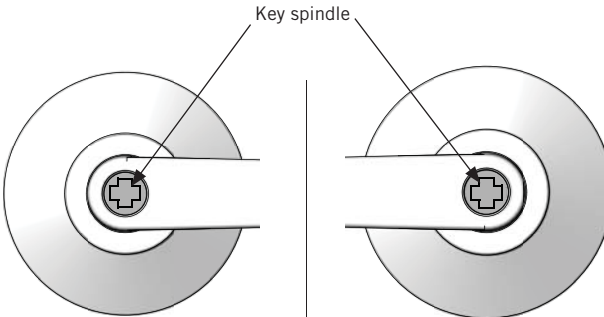

III. Removing & reassembling interchangeable core lever

**Removal**

1. Insert the control key into the IC core, rotate the key 15° clockwise, and remove the core and tail piece from the lever.

**NOTE: DO NOT REMOVE** the rubber stopper or security disc from the IC cylinder tailpiece. (Both parts are necessary on 6 & 7 pin cores.)

2. Using a flathead screwdriver, retract the lever catch inside the spindle and remove the lever.

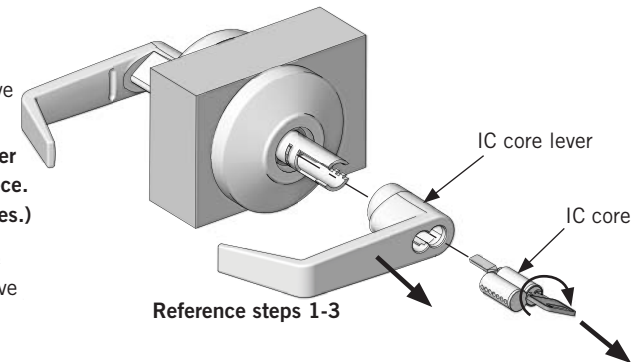

**Reinstallation**

3. Press the lever onto the spindle until it snaps into place.

4. **Install the tail piece on the core.** Insert the control key into the core, rotate the key 15° clockwise, push the core fully into the lever and turn counter clockwise 15 ° (home position), and remove the key.

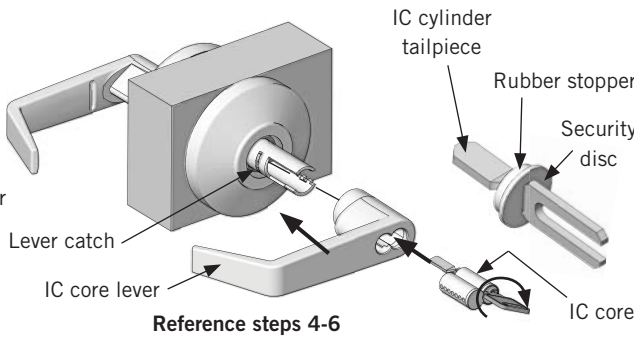

IV. Removing & reassembling standard cylinder lever (cylinder changes)

1. Remove the outside lever by inserting the key, turn clockwise and **hold** at 45°. Using the pick, depress the lever catch through the pick hole and remove the lever. Remove the key. (Figure 1a & 1b)

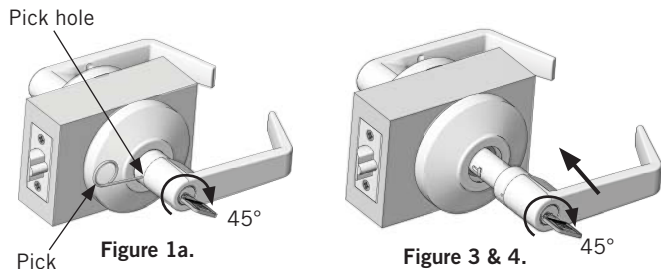

2. Remove the lever insert and cylinder. Replace with new cylinder and reinstall the lever insert. (Figure 2)

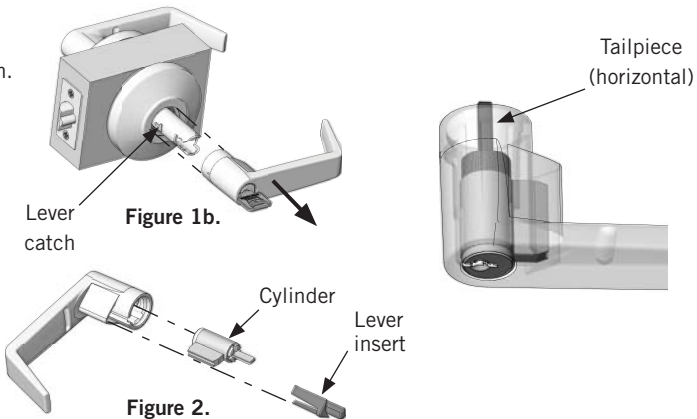

**⚠ Be sure the tailpiece is horizontal.**

3. Press the outside lever onto the spindle until it contacts the lever catch. (Figure 3)

4. Insert the key into the core, turn clockwise and **hold** at 45°. Press the lever fully onto the spindle until it clicks into place. Release the key. (Figure 4)

V. Dummy trim installation

**Single dummy trim**

1. Position the inside dummy rose insert on the door with the lever catch facing towards the door edge.
2. Secure to the door using four #8 combo screws.
3. Push the rose onto the rose insert oriented such that the rose notch is facing downward.
4. Push the inside lever onto the spindle until it clicks into place.

**Double dummy trim**

1. Insert the outside dummy rose insert into the through-bolt holes on the door with the lever catch facing towards the door edge.
2. Align the inside dummy rose insert and secure to the door using two #8 combo screws and two 10-32 x 1-1/2" screws.
4. Push the roses onto the dummy rose inserts oriented such that the rose notches are facing downward.
5. Push the levers onto the spindles until they click into place.

