

Saflok

Screwless RCU



Features

- Ability to easily integrate with Ambiance™ or System 6000™ software
- Environmentally sealed contactless smart card reader protects against climate extremes, which is an especially vital feature for common access readers placed in external building and exit device applications
- Compatible with Messenger ZigBee and Messenger™ Inncom RF
- Optionally equipped with the Messenger transceiver for centralized access control
- LED lights displayed behind high-impact polycarbonate reader lens
- Contactless smart card reader uses industry-standard Mifare ISO A14443 communication platform and high-security protocol
- USB connectivity to LPI probe
- Keycards are programmed using a contactless encoder
- Contactless communication between the keycard and the reader via RF waves
- Programmable auto latch/unlatch feature eliminates need for manual dogging
- Configurable for normally closed circuits (magnet latches) and normally open circuits (electric strikes)
- Auditable entries/attempts
- Selectable master key access
- Restricts access to guest keys after check-out date

Overview

From the development of SAFLOK's™ latest lock innovation, Quantum™ RFID, comes the Screwless RFID remote control unit (RCU) – a versatile stand-alone card reader controller. Through the application of contactless smart card technology, this remote control device is designed to work with all electrified access control devices for perimeter doors, concierge floors, common areas, and other secured areas with electrified hardware.

This device will complement your already comprehensive SAFLOK security design to maximize the efficiency of your operations today and into the future without the exposed hardware.

Specifications

- SPDT 5A@30VDC relay with common, normally open and normally closed contacts

Voltage

- 12-24 VAC or VDC

Requirements

- Double-gang switch box

Access management software

The Screwless RFID RCU is supported by dormakaba's robust access management software solution that features an array of access control workflows for both guest and staff access. Optionally, choose dormakaba's online access management solution for superior control and monitoring.

Screwless Face Plate 4.54" W, 4.57"H

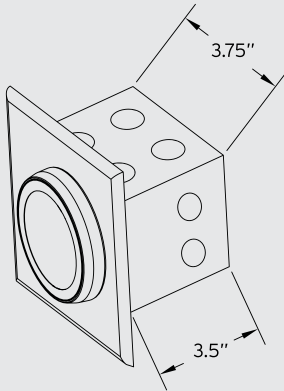

Screwless RCU flush mount

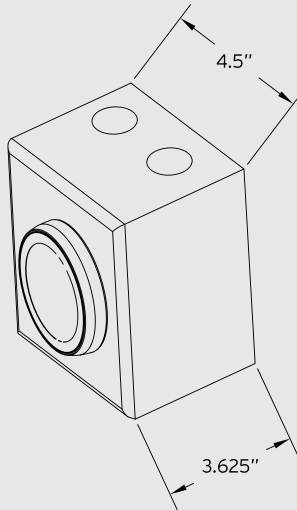

Screwless RCU surface mount

Face plate finish options



White - WH

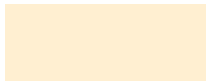

Beige - BE



Ivory - IV

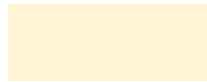

Almond - AL



Light Almond - LA



Gray - GR



Taupe - TP



Black - BL



Brown - BR



Sienna - SI

© dormakaba 2024. Information on this sheet is intended for general use only.
dormakaba Canada reserves the right to alter designs and specifications without notice or obligation.

Any questions? We would be happy to assist.

Contact us at: 800-265-6630