

# dormakaba terminal 96 00

## Design meets function

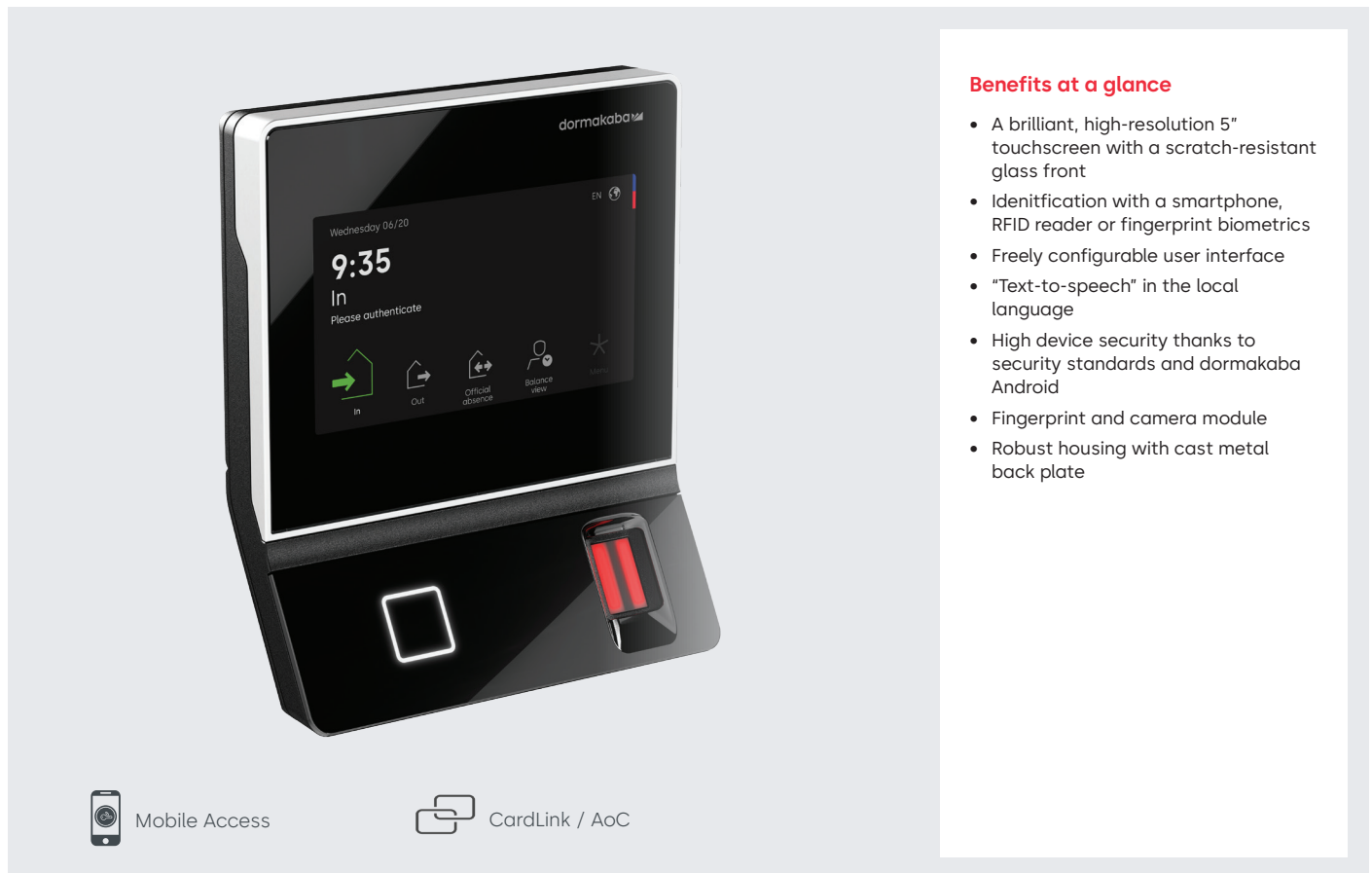

### Benefits at a glance

- A brilliant, high-resolution 5" touchscreen with a scratch-resistant glass front
- Identification with a smartphone, RFID reader or fingerprint biometrics
- Freely configurable user interface
- "Text-to-speech" in the local language
- High device security thanks to security standards and dormakaba Android
- Fingerprint and camera module
- Robust housing with cast metal back plate

The dormakaba terminal 96 00 from the new K7 terminal generation sets new standards in efficiency through the use of energy-saving hardware components and a proximity sensor. Modern technologies enable reliable time recording and offer a variety of intelligent functions such as "text to speech". The high-resolution touchscreen display reacts instantaneously and therefore enables intuitive operation while the robust design ensures durability and reliability.

The dormakaba terminal 96 00 impresses with its user-friendly interface and simple integration into existing systems.

Employees are identified using an RFID card or smartphone on the integrated multi-RFID reader. Alternatively, you can also opt for biometric identification which offers simplified user administration as well as improved convenience and protection against buddy-punching.

In addition to time recording, the dormakaba terminal 96 00 offers you the option of door control or can serve as a CardLink/AoC update terminal for your access solution.

### Choose from different function variants:

Terminal 96 00 is available in the function variants 96 20, 96 40 and 96 60. This makes it quick and easy to select the required range of functions.

dormakaba terminal 9600-K7	96 20	96 25	96 40	96 60
<b>Device software</b>				
B-Client_HR40	●	–	●	●
B-Client_XML40	–	●	–	–
<b>Identification</b>				
Multi-RFID reader, LEGIC / MIFARE (SM6300)	○	○	○	○
HID - iCLASS SE, iCLASS, Prox, Prox II	○	○	○	○
Fingerprint biometrics (CBM)	○	○	○	○
<b>Host interface</b>				
10/100/1000 Ethernet interface (IPv4, IPv6)	●	●	●	●
WLAN	○	○	○	○
<b>Applications</b>				
Mobile Access	●	–	●	●
CardLink/Access on Card (AoC)	–	–	●	●
Door control	–	●	–	●
Loudspeaker	●	●	●	●
Energy Saving Mode with proximity sensor	●	●	●	●
RGB camera	○	○	○	○
<b>Memory Capacity</b>				
50,000 master records	●	●	●	●

Standard ●  
Optional ○  
Not available –

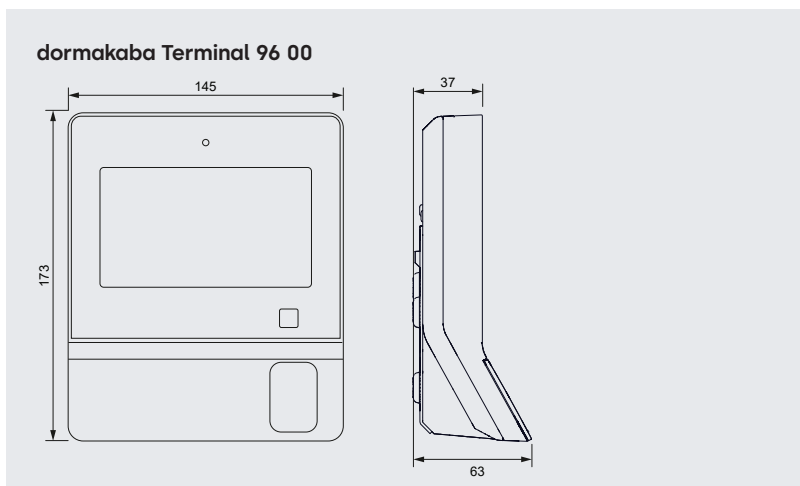

## Technical data

### System

- 5" touchscreen 1,080 x 720 pixels
- CPU: i.MX8M Mini Quad Processor
- Memory: 4 GB RAM, 16 GB eMMC Flash
- Operating system: dormakaba Android (updateable)
- Audio: Integrated loudspeaker (1 W)
- Real-time clock
- Tamper switch

### Interfaces

- Internal I/Os (2 digital inputs, 1 output)
- 1x USB 2.0, type C

### Power supply

- PoE (IEEE 802.3at)
- Power class 0 (0.44–12.95 W)

### Environment

- Ambient temperature: –20 °C to +55 °C
- Relative humidity: 5% to 85% (non-condensing)
- Class of protection according to IEC 60529: IP20/IP65 (depending on version)
- Impact resistance: IK08

### Design and material

- Robust plastic housing with wall mounting plate
- Hardened-glass device front
- Cast metal back plate (ZAMAK)
- Mounting with VESA mount VESA MIS-D possible

### Dimensions (W x H x D)

- 145 mm x 173 mm x 63 mm

You will find further details and order information in the relevant dormakaba catalogues and system descriptions.

Subject to technical modifications.  
© 2025 dormakaba. Edition 02/2025



Any questions? We will be happy to assist you.