

**Montageanleitung
DORMA RSP 80
Schiebetür an Wand**

**Mounting instruction
DORMA RSP 80
Sliding door to wall**

Wichtige Informationen:
Important information:

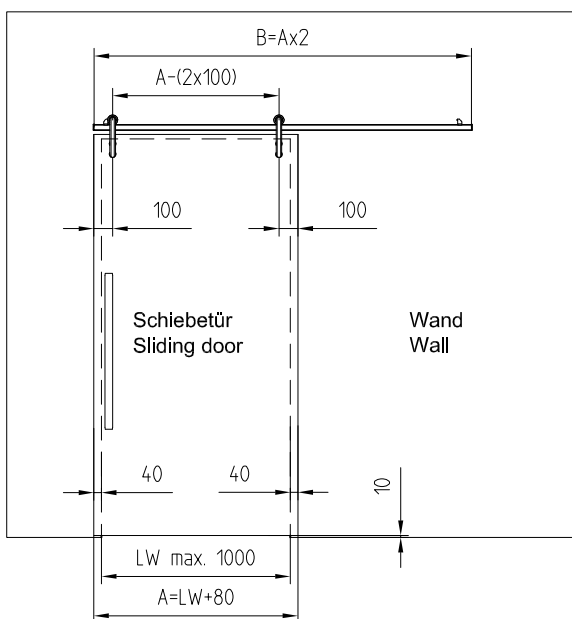

① = Bauteil/Baugruppe
 Component

1. ; 1.1 ; ... = Montagefolge
 Mounting sequence

Vor der Montage Glasflächen
 mit handelsüblichem Glasreiniger
 im Bereich der Klemmflächen reinigen.

All glass clamping areas are to
 be cleaned with standard glass
 cleaning products prior to installation.



keine Verdünnung verwenden
 Do not use thinners

- A = Glasbreite / glass width
- B = Laufschiene/nlänge / length of track
- GH = Glashöhe / glass height
- TH = Türhöhe / door height
- LH = Lichte Höhe / clear opening height
- LW = Lichte Weite / clear opening width
- t = Glasdicke (8/10 mm) / glass thickness (8/10 mm)
- u = Holzdicke (25 - 40 mm) / wood thickness (25 - 40 mm)

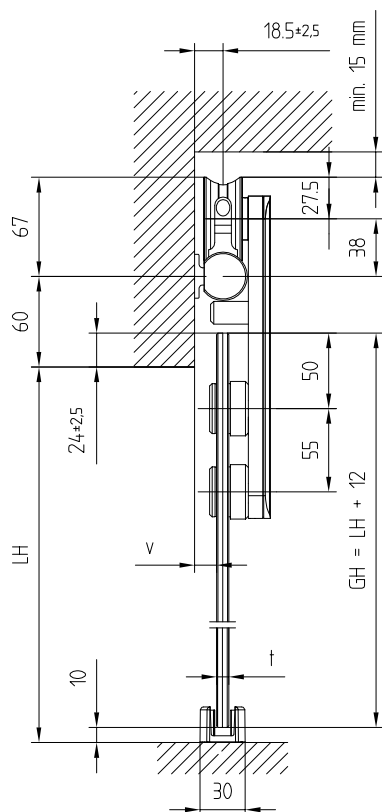

t	v
8 mm	14,5 mm
10 mm	12,5 mm

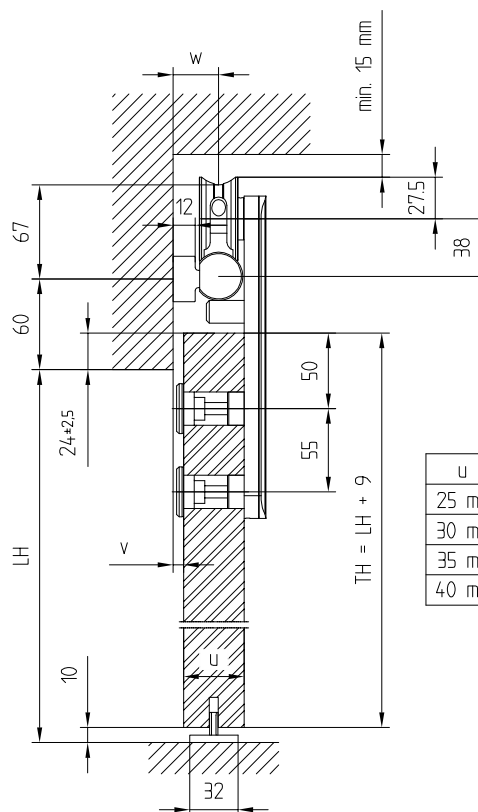

u	v	w
25 mm	10,3 mm	18,5 mm
30 mm	17,3 mm	30,5 mm
35 mm	12,3 mm	30,5 mm
40 mm	7,3 mm	30,5 mm

Glasbearbeitung:
Glass preparation:

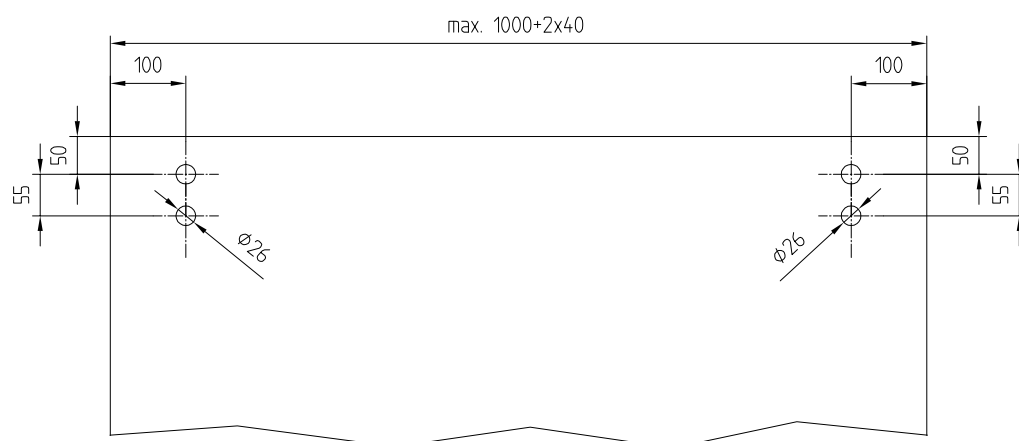

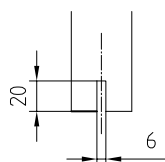
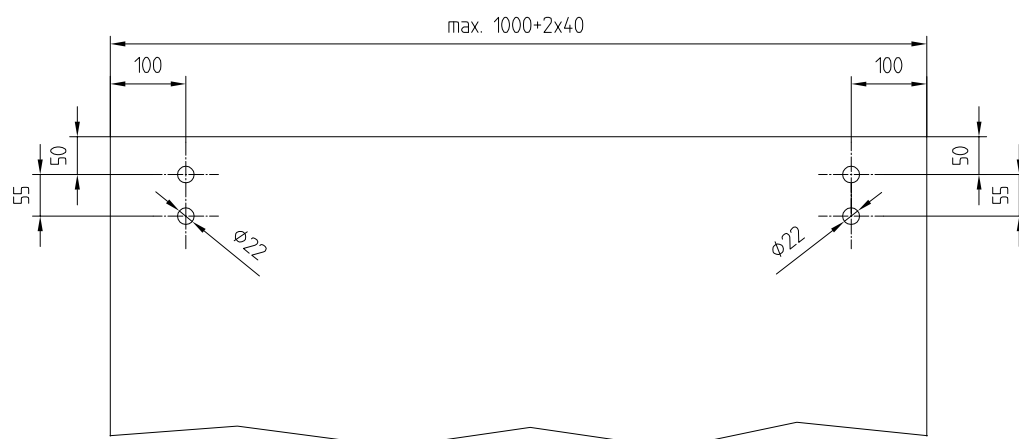

Holztürbearbeitung:
Wooden door preparation:

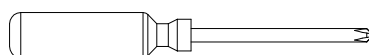
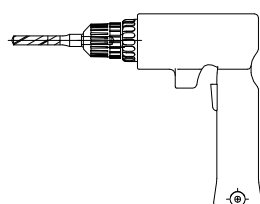

Montagewerkzeug:
Requisite tool:

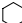

-  2 mm
-  3 mm
-  4 mm
-  5 mm

Lieferumfang:
Scope of delivery:

Glas Anbindung
Glass connection

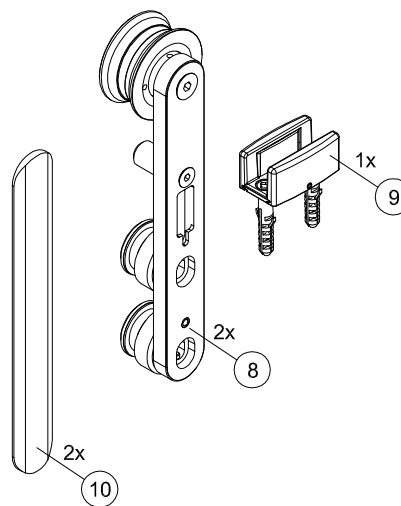
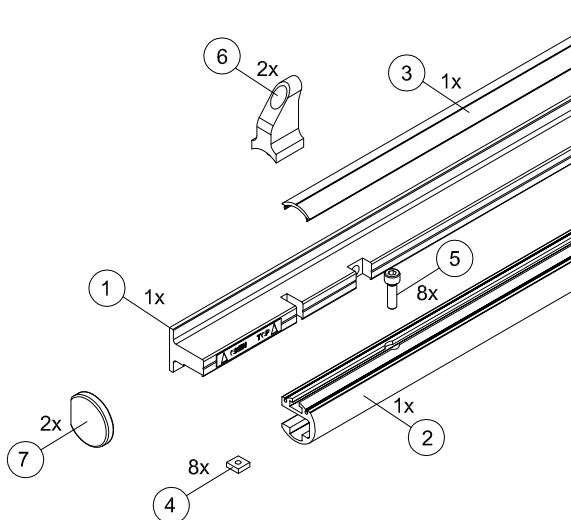

Schrauben und Dübel zur Wandbefestigung sind nicht im Lieferumfang enthalten!



Screws and wall plugs for wall connection are not included in delivery!

Holz Anbindung
Wooden connection

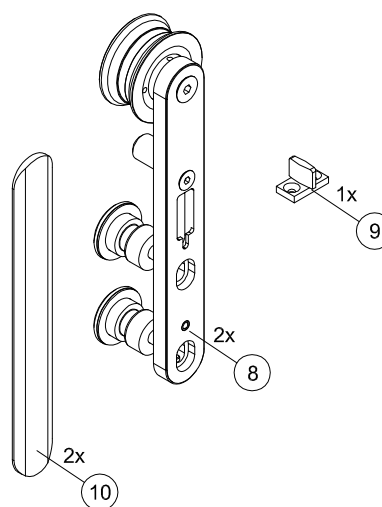
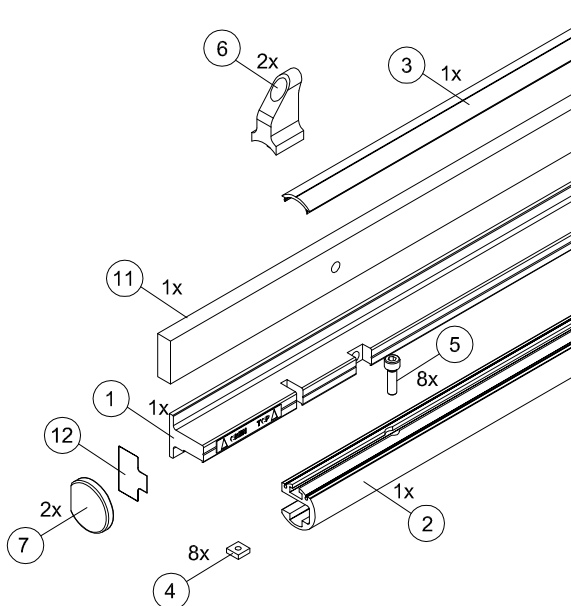

Schrauben und Dübel zur Wandbefestigung sind nicht im Lieferumfang enthalten!



Screws and wall plugs for wall connection are not included in delivery!

Lieferumfang:
Scope of delivery:

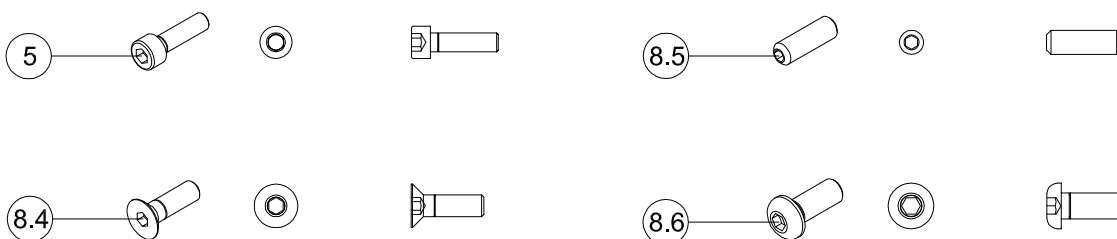

1. T-Profil an Wand schrauben:
1. Mounting of T-profile onto wall:

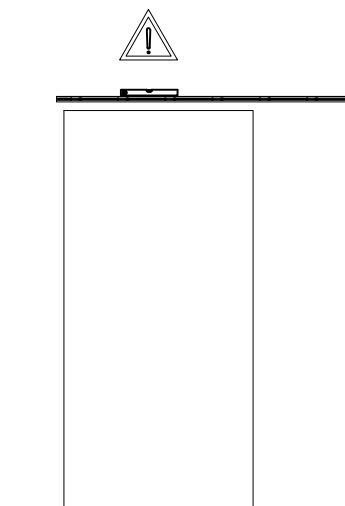

Schrauben und Dübel zur Wandbefestigung sind nicht im Lieferumfang enthalten!



Screws and plugs for wall connection are not included in delivery!

Glas Anbindung
Glass connection

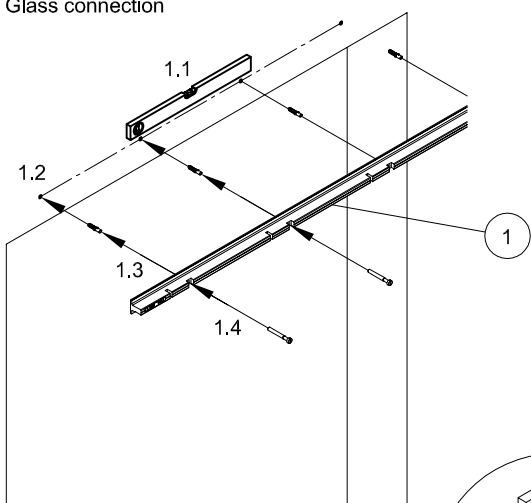

Holz Anbindung
Wooden connection

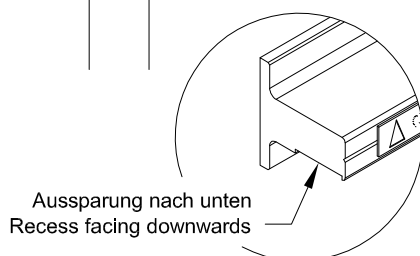
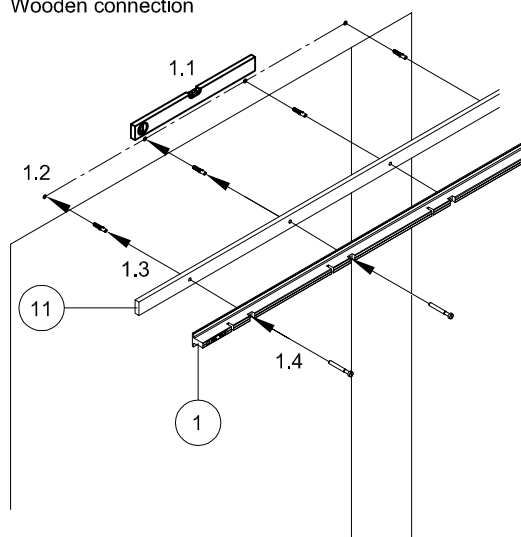

**2. Vorbereitung des Laufschienenprofils:
2. Preparing of the track rail profil:**

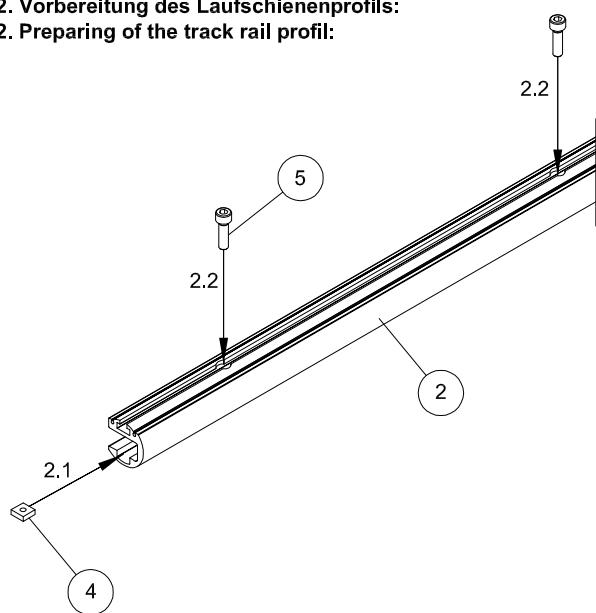

2.2 Schrauben einen Gewindegang in Nutsteine schrauben!
2.2 Tighten screws one convolution in slot nuts!

**3. Laufschiene auf T-Profil verschrauben:
3. Mounting of track profile on T-profile:**

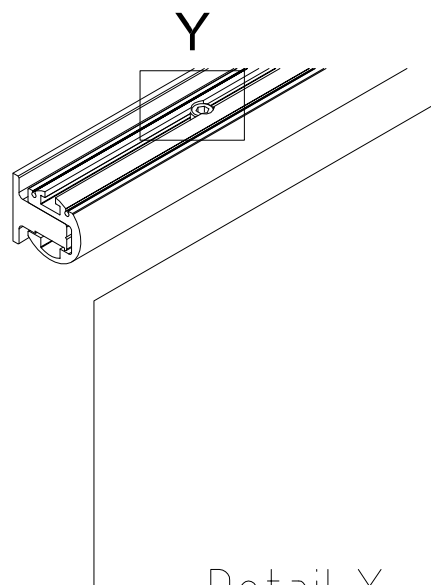
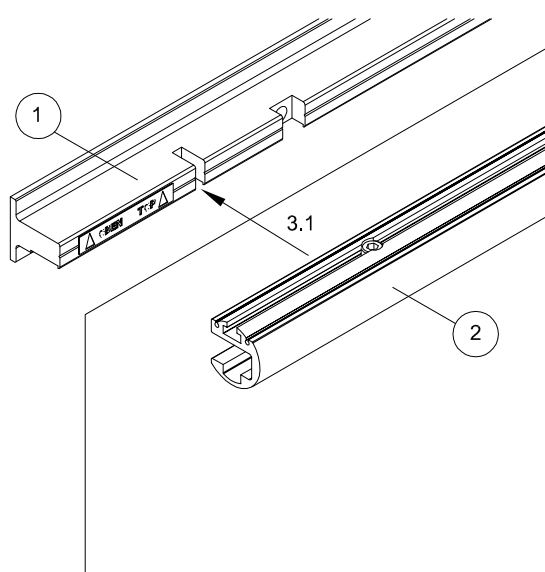

Detail Y

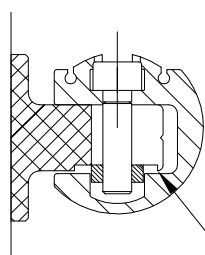

Aussparung nach unten
Recess facing downwards

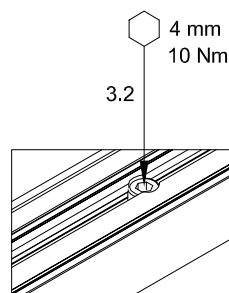

4 mm
10 Nm

4. Rollprofil auf Laufschiene klippen:
4. Roll-profile connect to track rail:

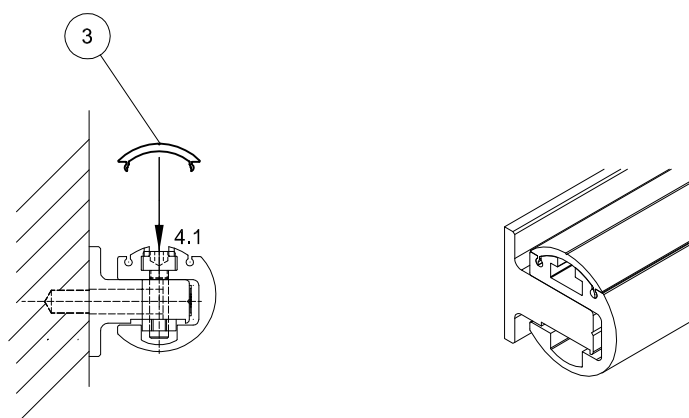

5. Vorbereitung Rollenwagen:
5. Preparing the track rail:

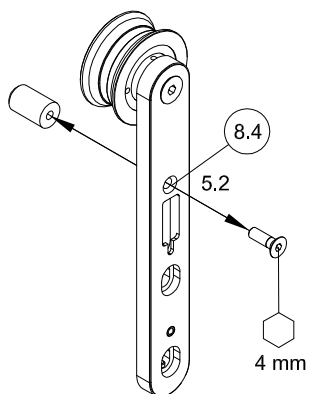
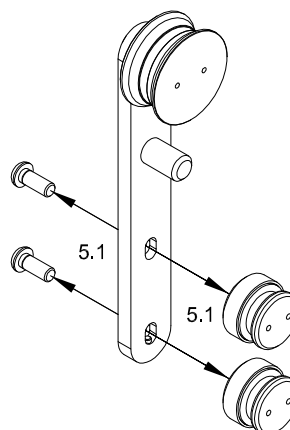
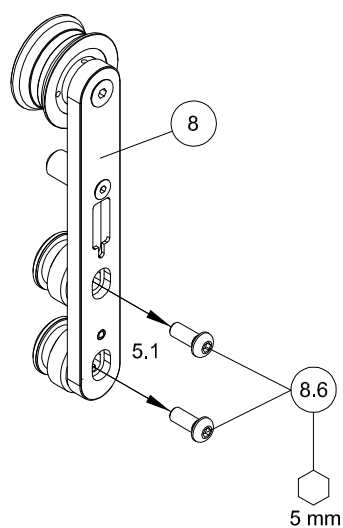

6. Montage Rollenwagen an Glas:

6. Mounting roller on glass:

6.3 Aufstecken und leicht anschrauben

6.3 Attach and tighten easily

Glas Anbindung
Glass connection

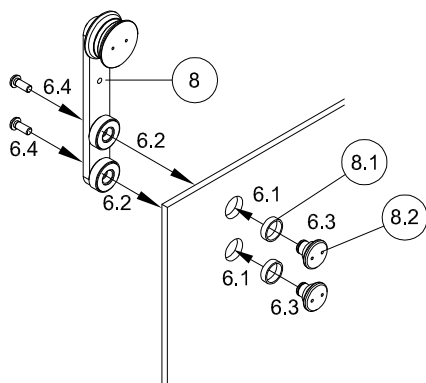

Holz Anbindung
Wooden connection

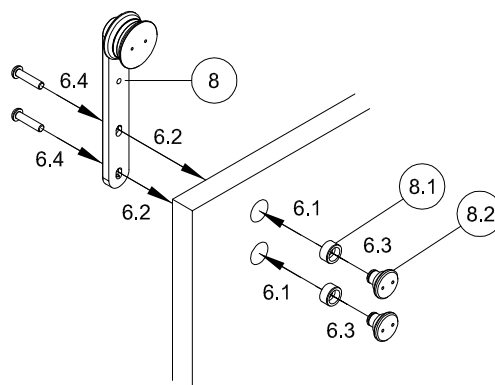

7. Bodenführung montieren:

7. Mounting of the floor guide:

7.1 Schiebetür einhängen und Bodenführung (9) markieren

7.1 Fit sliding door and mark the floor guide (9)

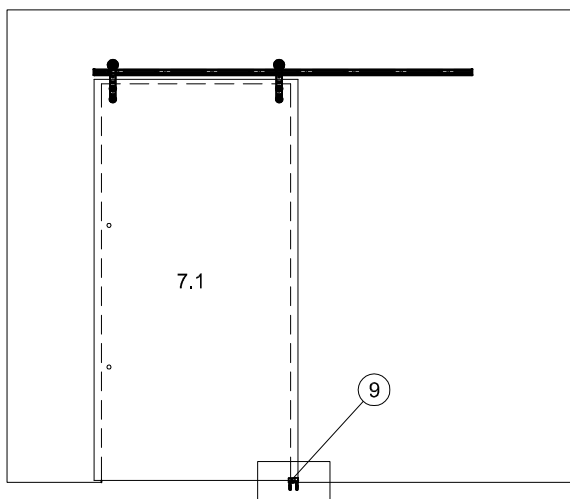

Glas Anbindung
Glass connection

Ansicht von oben
Top view

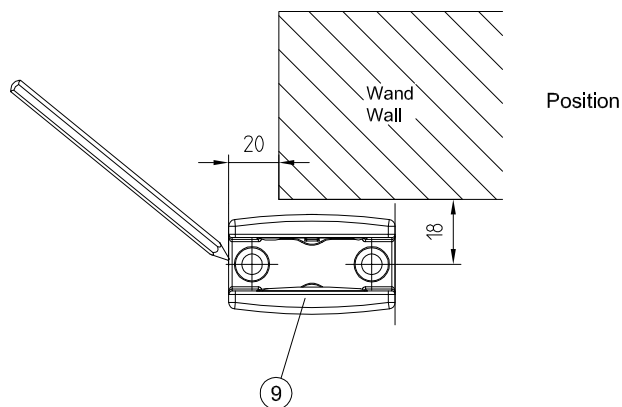

Holz Anbindung
Wooden connection

Ansicht von oben
Top view

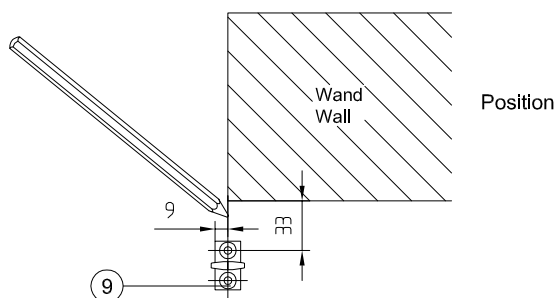

**7. Bodenführung montieren:
7. Mounting of the floor guide:**

7.2 Schiebetür aushängen und Bohrungen markieren
7.2 Lift out sliding door and mark the holes

Detail W

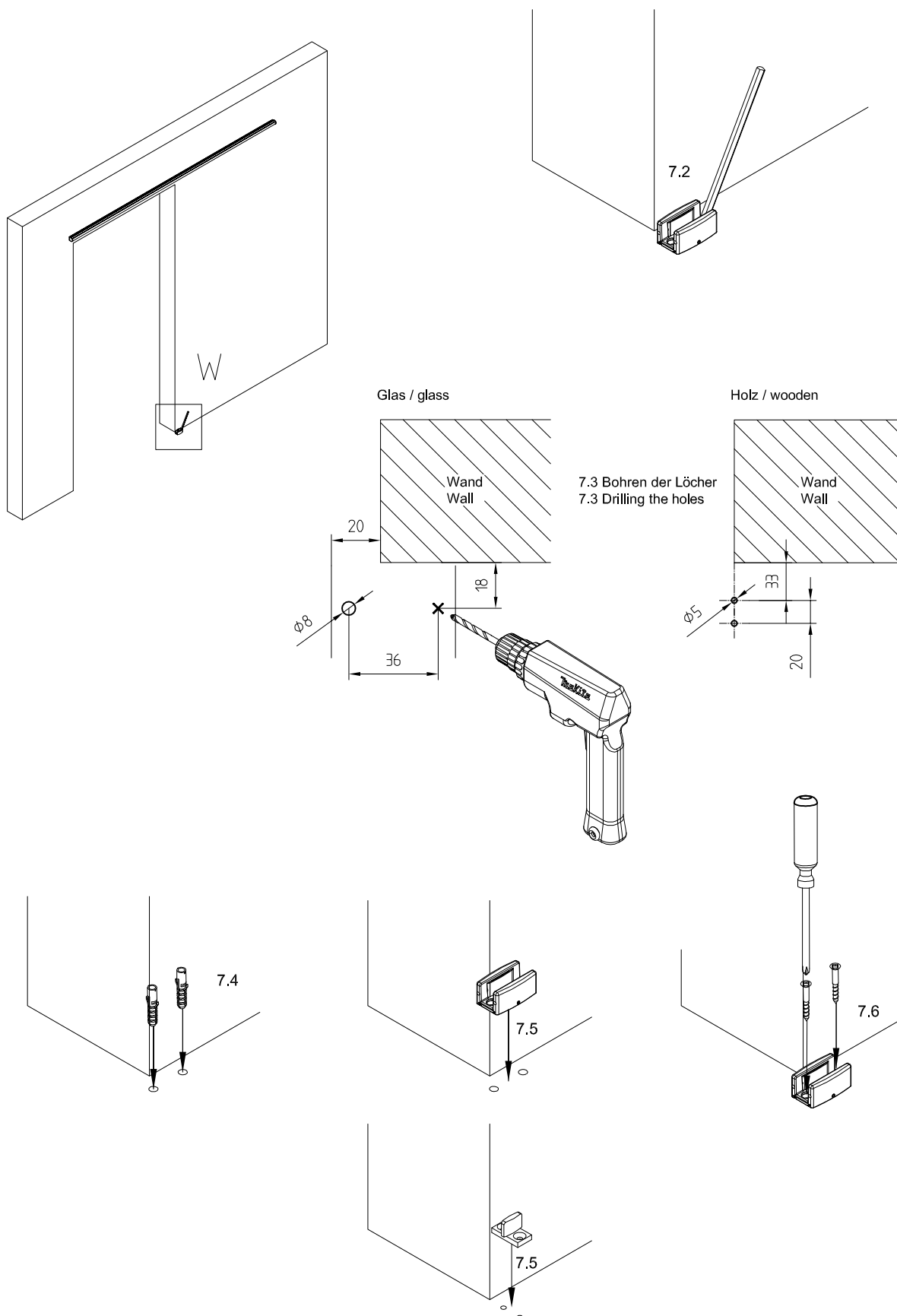

8. Türstopper montieren:
8. Mounting of the door stoppers:

8.1 Schiebetür einhängen
 8.1 Fit sliding door

8.2 Tür vollständig schließen
 8.2 Close the door completely

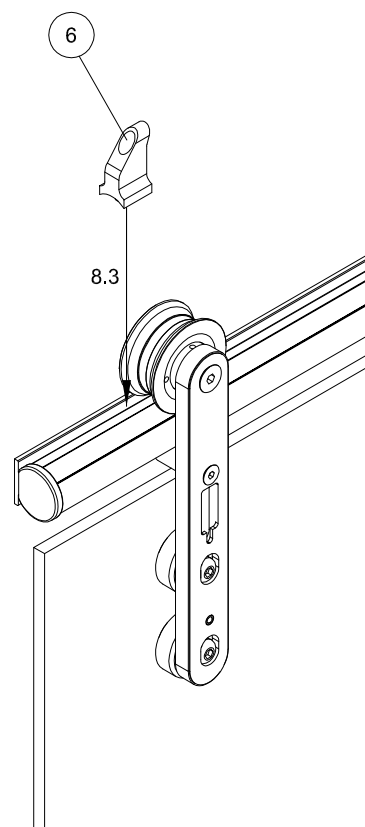
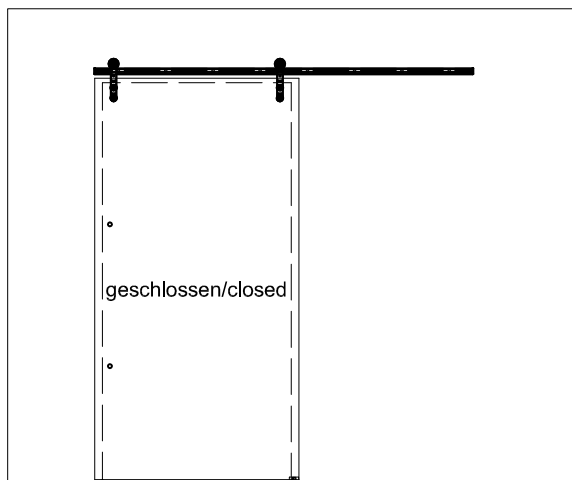

8.4 Tür vollständig öffnen
 8.4 Open the door completely

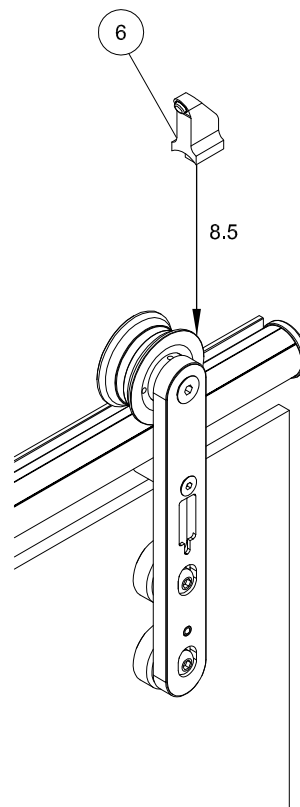
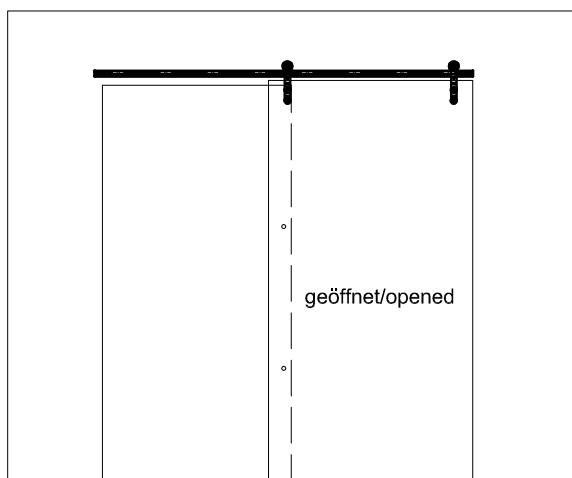

8. Türstopper montieren:
8. Mounting of the door stoppers:

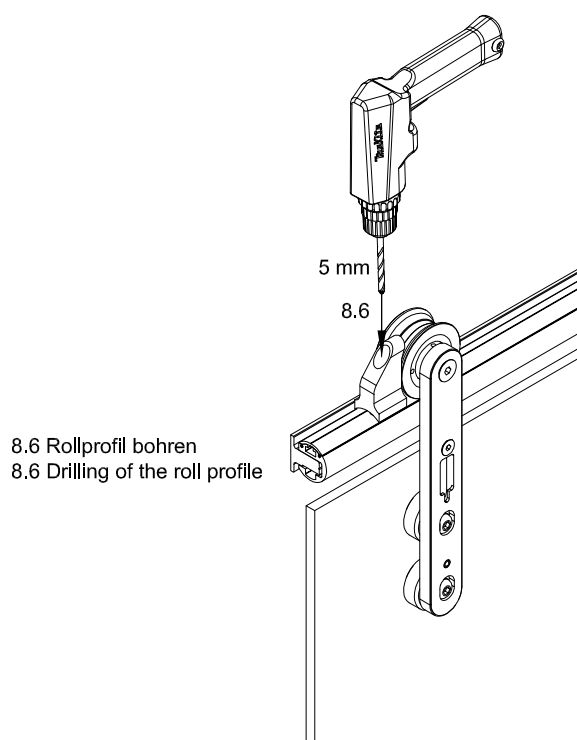

Nur das Kunststoffprofil bohren.
 Only drill the plastic profile.

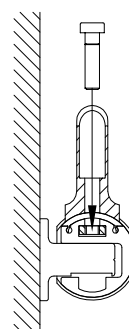
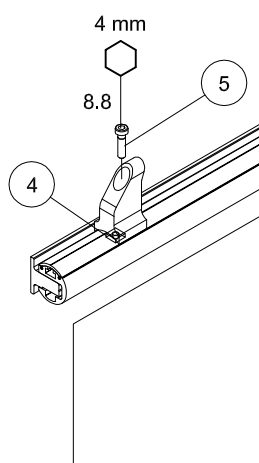
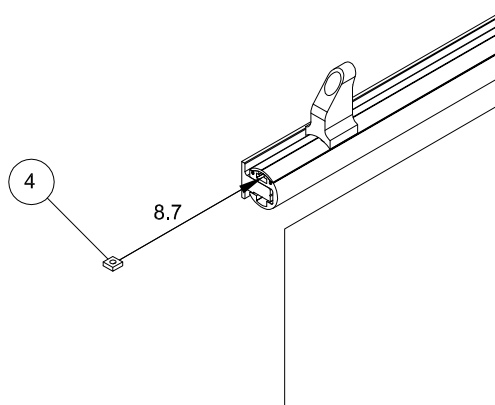

9. Abdeckkappen befestigen:

9. Fasten of the cover caps:

9.0 Folienstreifen abziehen und Dekofolie (12) aufkleben

9.0 Pull off backing tape and glue on the decoration strip (12)

9.1 Folienstreifen (7.1) abziehen und Kappen (7) aufkleben

9.1 Pull off backing tape (7.1) and stick on the cover caps (7) into right place

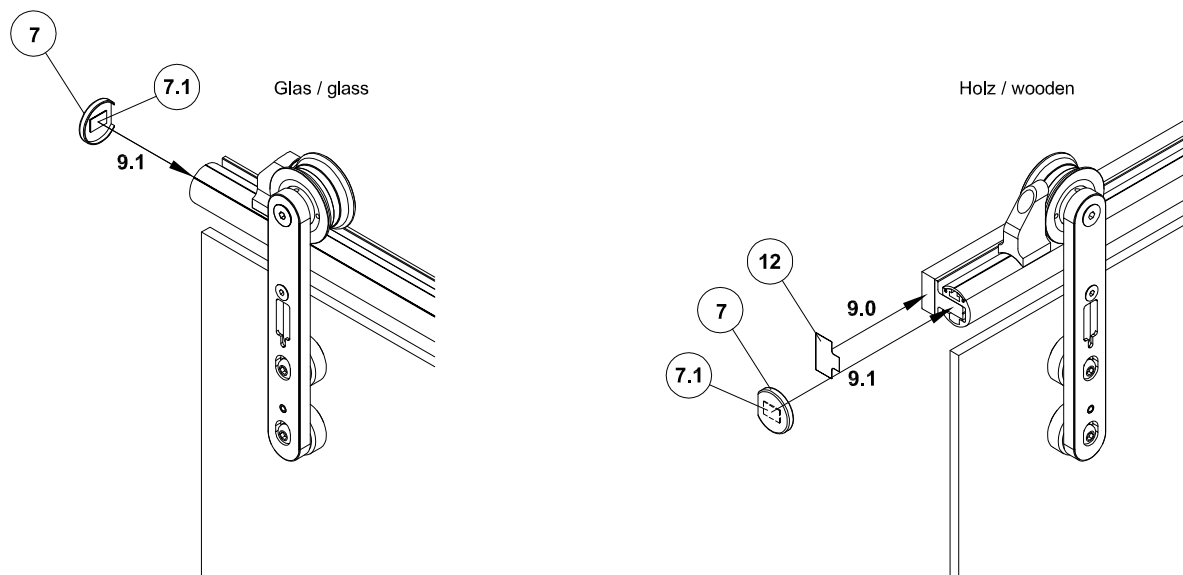

10. Aushebeschutz montieren:

10. Mounting of the antijump mechanism:

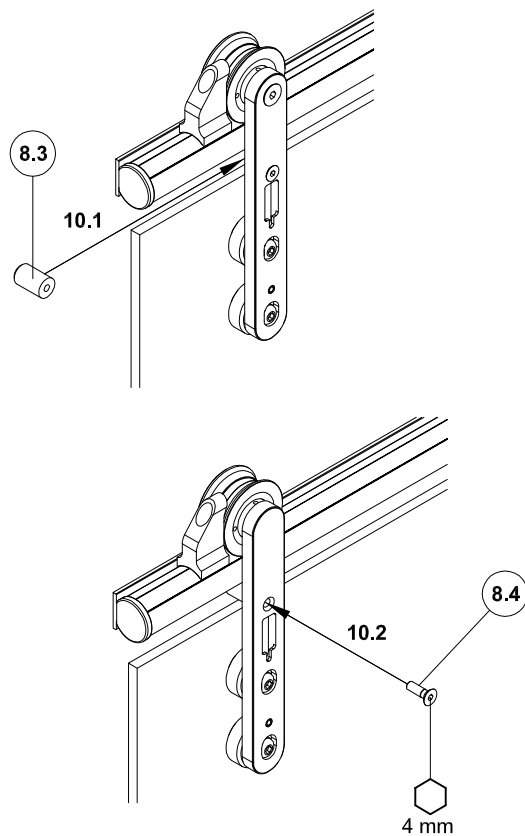

**11. Tür einstellen:
11. Adjusting of the door:**

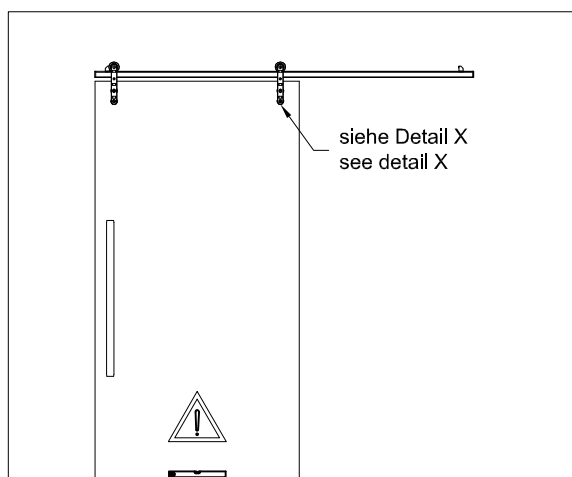

Detail X

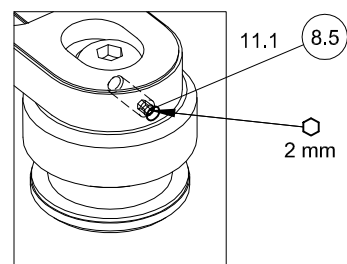

11.1 Justieren der Punkthalter mit Hilfe des Gewindestifts

11.1 Adjust the single-point fixings via the setscrew

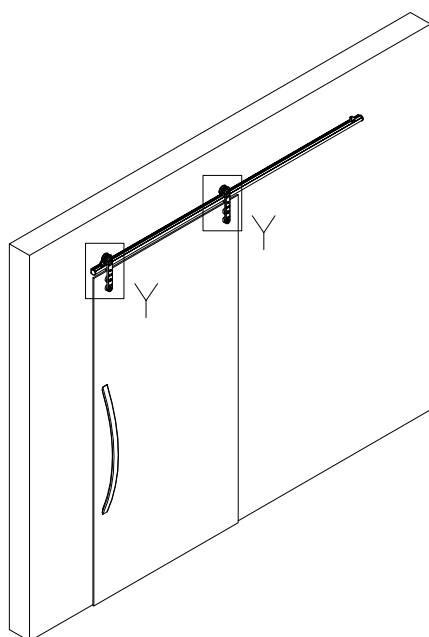

Detail Y

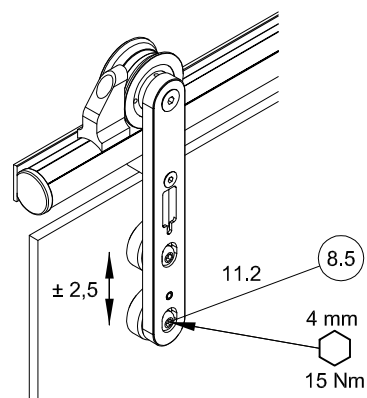

**12. Abdeckkappen auf Rollenwagen montieren:
12. Mounting of the cover caps on roller:**

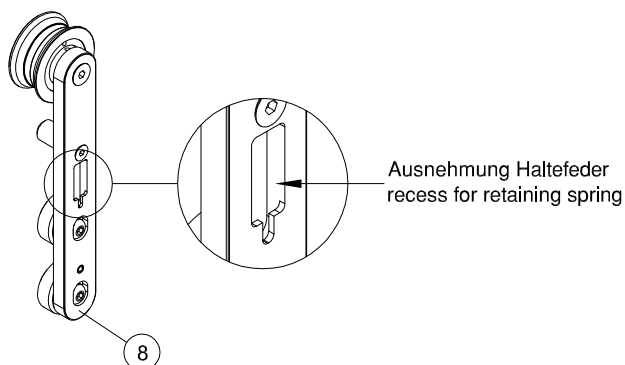
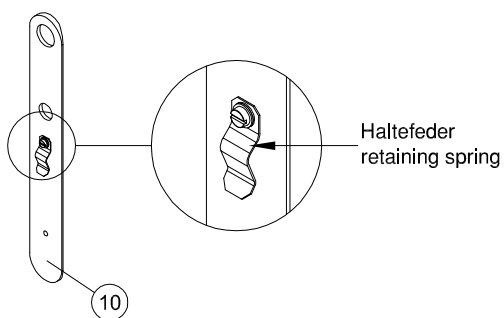

**12. Abdeckkappen auf Rollenwagen montieren:
12. Mounting of the cover caps on roller:**

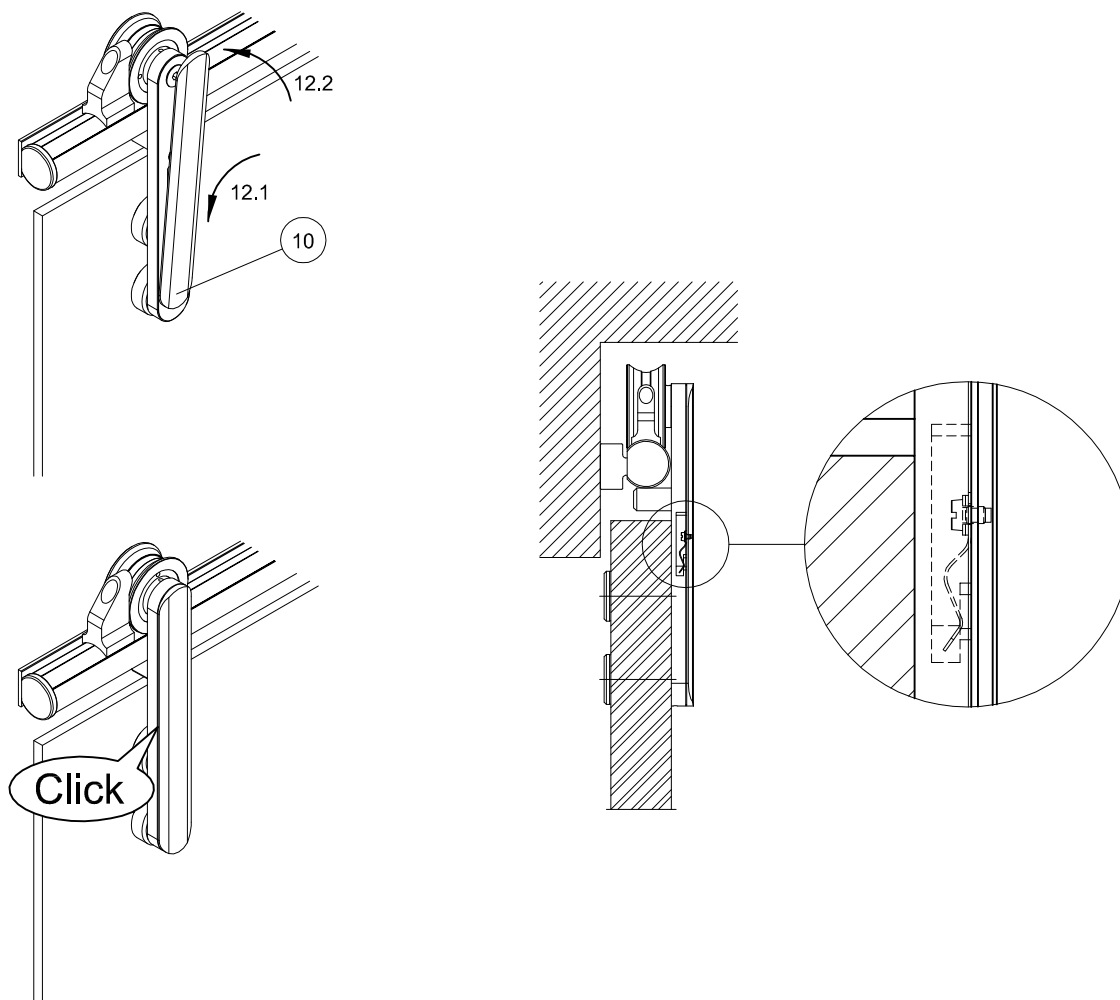

**12. Demontage der Abdeckkappen:
12. Removing of cover caps:**

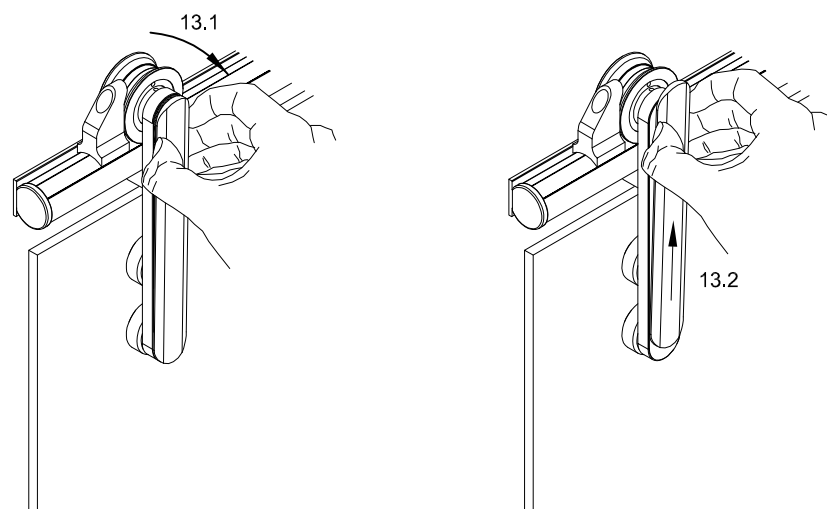

13. Glaskantenschutz:
13. Glass edge protection:



Vor dem Aufkleben Glaskanten im Bereich der Klebeflächen reinigen. Bitte nur Glasreiniger verwenden, die frei von Silikonen und Ölen sind (z.B. Aceton).



The glass edges are to be cleaned prior to affix. Only use glass cleaning products, free from silicones and oil (e.g. acetone).



Glaskantenschutz abziehen.
 Pull-off the glass edge protection.

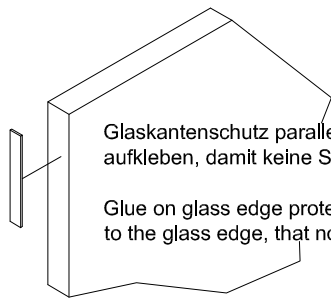

Glaskantenschutz parallel zur Glaskante mittig aufkleben, damit keine Schleifgeräusche entstehen!
 Glue on glass edge protection parallel and centred to the glass edge, that no rubbing noise occur!

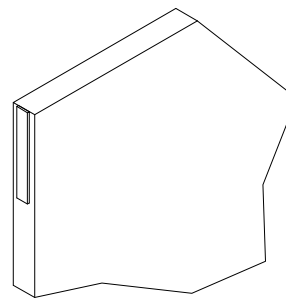

Glaskantenschutz vollständig (ohne Blasen) aufkleben, damit die volle Haftung erreicht wird!
 To attain the full adhesion, glue on glass edge protection completely (without bubbles)!

Einzeltür in Nische oder gegen Wand:
Single door in a niche or against wall:

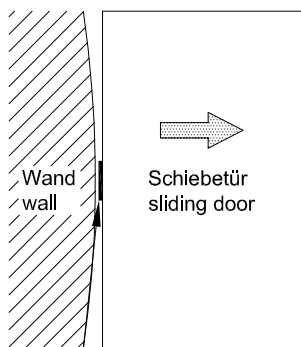

Glaskantenschutz
 glass edge protection

Glaskantenschutz im Kollisionsbereich zur Wand aufkleben.
 Glue on glass edge protection onto glass, in area of possible collision with wal.

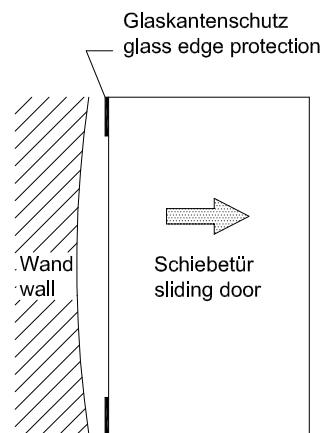

Glaskantenschutz
 glass edge protection

Glaskantenschutz
 glass edge protection

Doppeltür:
Double door:

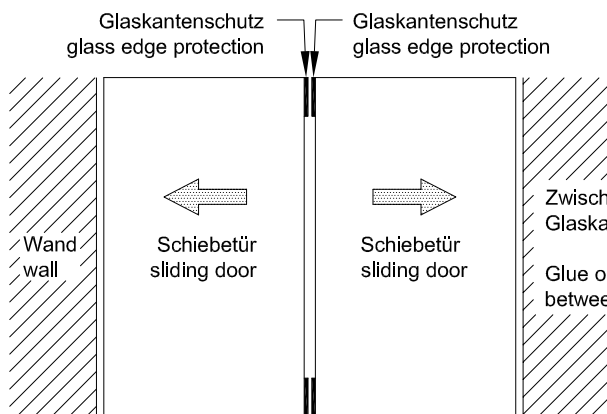

Glaskantenschutz
 glass edge protection

Glaskantenschutz
 glass edge protection

Wand
 wall

Schiebetür
 sliding door

Schiebetür
 sliding door

Zwischen den Flügeln den
 Glaskantenschutz aufkleben.
 Glue on glass edge protection
 between the panels.

Glaskantenschutz
 glass edge protection

Glaskantenschutz
 glass edge protection