

WN 800.52.230.6.32, 06/13

**Beidseitige Griffstange / Türknauf für 13,5 / 15 / 17,5 / 19 / 21,5 mm Glasdicke**  
**Pair of handle bar / door knob for 13,5 / 15 / 17,5 / 19 / 21,5 mm glass thickness**

**Lieferumfang:**  
**Scope of delivery:**

Vormontiert für 21,5 mm Glas  
 Preassembled for 21,5 mm glass thickness

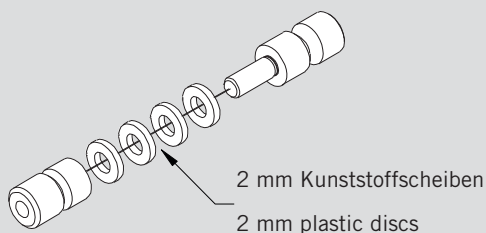

**Verwendung bei geringeren Glasdicken:**  
**In case of use for smaller glass thickness:**

Bolzen auseinander schrauben und entsprechend der Glasdicke, Scheiben entnehmen.  
 Disassemble the bolt and remove discs according to glass thickness.

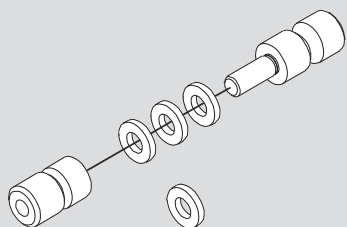

19 mm Glas  
 19 mm glass

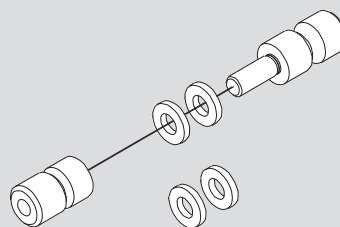

17,5 mm Glas  
 17,5 mm glass

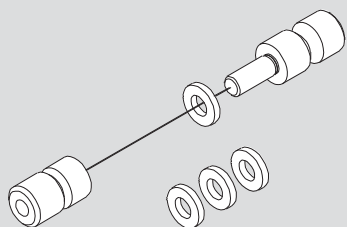

15 mm Glas  
 15 mm glass

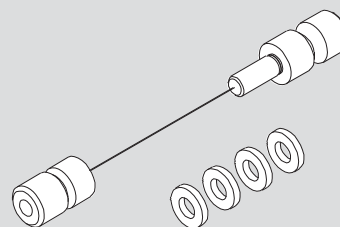

13,5 mm Glas  
 13,5 mm glass

Griffstange gemäß Montageanleitung an das Glas montieren.  
 Please follow the handle bar assembly instruction.

Änderungen vorbehalten  
 Subject to change without notice